

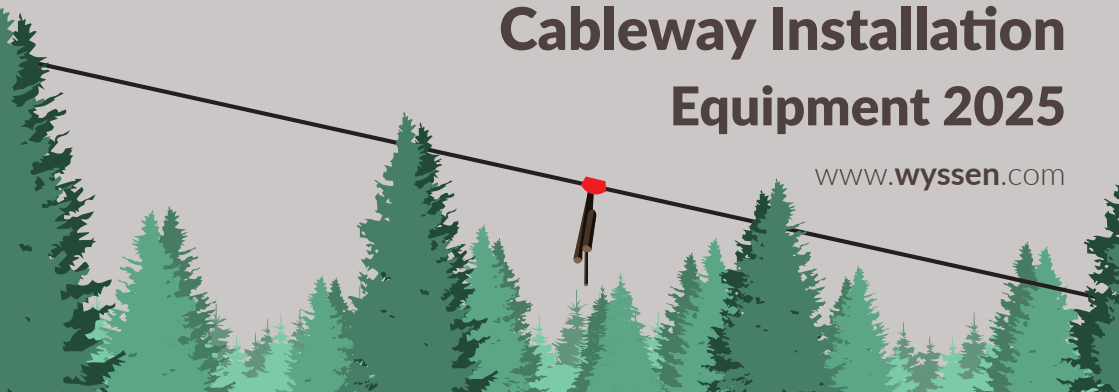

Cableway Installation Equipment 2025

www.wyssen.com



Contents

4	Cable deflection rollers	28	Clamps
6	Cable snatch blocks especially for rear cable winches	30	Shackles
6	Triple Pulley Blocks with mounting bracket	31	Aluminium anchor roller for shackles
7	Automatic cable deflection roller	32	Oval ring
7	Mainline idler pulley	32	Wyssen plate clamp
7	Double deflection roller	33	Anchoring clamp
8	Cable carrier with brake	33	Cable warning device (signal ball), aviation obstacle
8	Traversable cable carriers	34	Ackja cable winch
9	Terminal mast block with clamp	34	Maasdam cable puller
9	Clamp for terminal mast block	35	Habegger Hit wire rope hoist
10	Spar tree saddle	36	Mainline for Habegger manually operated wire rope hoist
11	Support saddles	37	Habegger Hit-Trac power-driven hoists
12	Skyline support saddle type 2.5	37	Traction cable for Habegger power-driven hoists
12	Skyline support saddle type 5	40	Small Cableway 100 kg
13	Special shakles	42	Automatic skyline clamp
13	Accessories for the skyline support saddle	44	Electronic tension measurement device Wyssen
14	Mainline cable pulley blocks	45	PIAB tension measurement device
14	Curve saddle	45	Wyssen compass
15	Support balances	46	Skymule Plantation Cableway
16	DQT-Support material	48	Inclinometer
16	DQT-Support elements	48	Terrain measurement device
16	Single DQT support	48	Multi-tree anchor
16	Double DQT support	49	Cable tensioner
17	Triple DQT support	49	Rock anchor plate
17	A-DQT-supports	50	Accessories for the rock anchor plate
17	Screw / Washer / Nut	50	Wyssen titanium anchor
18	Cable slings	51	Anchor bracket staple with cross- plateanchors
19	Choker ring	51	Anchor brackets for concrete anchors
19	Choker slings	52	Anchor brackets for automatic skyline clamp
20	Cable sling with sliding hook	52	Rotatable anchor
20	Pre-fabricated steel wire cables	52	Wire rope cutter
20	Sling hooks (cable lock, slide)	53	Splicing tool
21	Wire rope slings	55	Wyssen safety belt
22	Anchoring cables	55	Wyssen climbing spikes
23	Cable reels	56	Icom Radio Telephone
23	Cable capacities of the cable reels	57	Motorola Radio Telephone
24	Cable spool drive	58	Headphones and microphone for radio
25	Cable spool jack	58	Wyssen fan articles
25	Shafts and sleeves	59	Orders
26	Foot-operated winch		
26	Wyssen automatic clamp		
27	Wyssen automatic clamp (two attachment bolts)		
27	Bugnard cable tensioning clamp		
28	Crosby wedge socket		

Prices are subject to change!

Prices in EUR are indicative and based on the current exchange rate.

Programm overview

Wyssen Seilbahnen AG, Inventor of the skyline crane. Your partner with almost 100 years of experience in material cableways, skyline cranes and cable cranes.



Services

We offer you the necessary services such as consulting, project planning, sales, training enrolment and after-sales support.

Our highly-motivated and experienced staff is at your service.



Products

Our high-quality products include cable winches, carriages, self-propelling material single-line cableways, circulating cableways and skyline crane accessories for the highest demands and with long service life. Spare parts are available from stock.

(WLL = Working Load Limit)



Spare parts

We offer everything related to material cableways: the complete equipment from cable to cable winches, from carriages to accessories for assembling and operation.

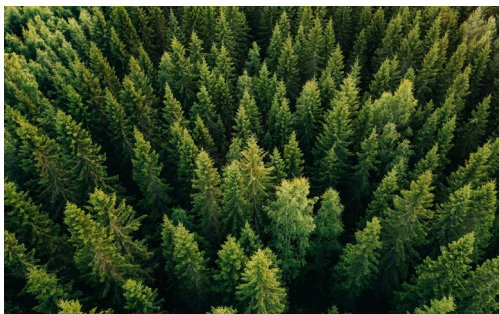

Sustainability

The use of the Wyssen skyline crane in the forest enables wood harvesting that protects the ground without dragging logs across the forest floor. It allows direct access to difficult terrain and is an environmentally friendly alternative to forest roads. Transport is energy-efficient thanks to gravity, and air transport protects vegetation while supporting the natural regeneration of the forest.

Cable deflection rollers

The high quality Wyssen cable deflection rollers have been specially developed for skyline crane construction and operation, but today they are used for all types of hoisting and ground traction work.

All our cable deflection rollers have a safety factor of 5. The models made of steel are particularly suitable for fast-running cables with a high load. The blocks made of aluminium/ plastic are on account of their light weight ideally suitable for assembly work (for manual operation only). The permanently lubricated ball-bearings and the high-strength materials guarantee a long service life. The rollers are equipped with cable derailment guards, so that derailling or any damage to the wire cable is not possible.

The deflection rollers can be opened up in a hanging position on slings and the cable can be simply inserted. Various models are available in a wide range, so that e.g. sleeves or cable connections can be drawn through when threading the cable. Individual spares are available for all rollers.

We will be pleased to offer you more rollers on request.

Markings

The technical information is provided on one of the side panels of the pulley. This information includes general data about the pulley.

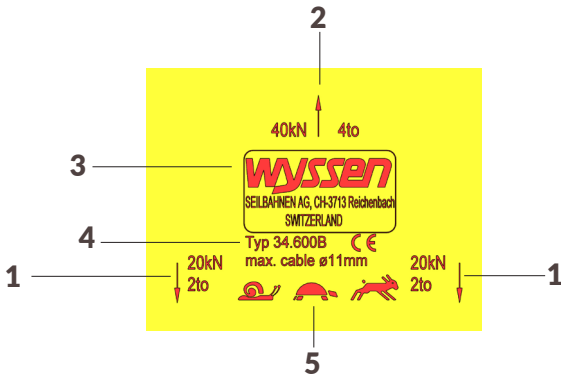

- 1 Max. load on one end of the rope
- 2 Max. load on the deflection pulley
=2* (load on end of rope)
- 3 Manufacturer's address
- 4 Type of the rope pulley as well
the max. size of the rope to be used
- 5 Permitted types of use

Types of use

The deflection pulleys differ not only in their dimensions, but also in their functionality. The permitted types of use for each roller are indicated on a side panel. There are three different types of use. It is prohibited to use pulleys for operations for which the pulleys are not intended.



Operation with manual rope
hoists



Operation with motorised rope
hoists



Cable winches / cable crane
operation



Art. No.	Roller- \varnothing version	Material Plate Roller	Max. WLL on the bolt	Max. WLL cable pull at 180°	Cable- \varnothing up to Max. width	Weight	Cable Speed	CHF EUR
34.700	\varnothing 100 mm Standard	Steel	3'200 kg	1'600 kg	\varnothing 26 mm 27 mm	2.74 kg		359.00
		Steel						378.00
34.700A	\varnothing 100 mm Standard	Alu	3'200 kg	1'600 kg	\varnothing 12 mm 29 mm	1.23 kg		359.00
		Plastic						378.00
34.500B	\varnothing 140 mm Standard	Steel	3'200 kg	1'600 kg	\varnothing 10 mm 28 mm	4.50 kg		630.00
		Steel						664.00
34.600B	\varnothing 180 mm Standard	Steel	4'000 kg	2'000 kg	\varnothing 11 mm 30 mm	8.00 kg		793.00
		Steel						835.00
34.600BH	\varnothing 180 mm Standard	Stahl	4'000 kg	2'000 kg	\varnothing 11 mm 30 mm	8.00 kg		819.00
		Hardened steel						863.00
34.100A	\varnothing 240 mm Standard	Alu	5'000 kg	2'500 kg	\varnothing 12 mm 40 mm	8.50 kg		1'047.00
		Steel						1'103.00
34.100B	\varnothing 240 mm Standard	Steel	5'000 kg	2'500 kg	\varnothing 12 mm 36 mm	11.70 kg		1'290.00
		Steel						1'358.00
34.1000	\varnothing 230 mm Breit	Steel	5'000 kg	2'500 kg	\varnothing 36 mm 83 mm	21.20 kg		1'358.00
		Steel						1'430.00
34.200B	\varnothing 320 mm Standard	Steel	10'000 kg	5'000 kg	\varnothing 16 mm 50 mm	31.00 kg		2'368.00
		Steel						2'493.00
34.200BH	\varnothing 320 mm Standard	Steel	10'000 kg	5'000 kg	\varnothing 16 mm 50 mm	31.00 kg		2'441.00
		Hardened steel						2'570.00
34.2000	\varnothing 320 Breit	Steel	10'000 kg	5'000 kg	\varnothing 60 mm 100 mm	45.00 kg		3'081.00
		Steel						3'244.00
34.300B	\varnothing 400 mm Standard	Steel	20'000 kg	10'000 kg	\varnothing 24 mm 70 mm	59.00 kg		4'572.00
		Steel						4'813.00
34.3000B	\varnothing 390 mm Breit	Steel	20'000 kg	10'000 kg	\varnothing 80 mm 140 mm	94.00 kg		7'087.00
		Steel						7'460.00
34.100- 500	\varnothing 500 mm Spezial	Steel	4'000 kg	2'000 kg	\varnothing 12 mm 36 mm	38.00 kg		2'945.00
		Steel						3'100.00
34.800B	\varnothing 600 mm Standard	Steel	20'000 kg	10'000 kg	\varnothing 24 mm 70 mm	100.00 kg		6'856.00
		Steel						7'217.00





Cable snatch blocks especially for rear cable winches



The extremely light and strong aluminium-plastic cable snatch block has been specially developed for tough use with forestry cable winches for ground traction. The snatch blocks are predominantly used with any forestry cable winches for ground traction such as e.g. tractor and hauler cable winches and is available in two different sizes for winches with tractive forces of max. 10 t and max. 16 t.

Advantages:

- optimised for maximum load with minimum weight
- side plates and bolt made out of high-tensile aircraft aluminium, roller plastic
- ergonomic carrier handle
- hollow axle for suspending or fixing
- nut fixed to side plate
- secure fixation with threaded bolt
- specially wide to accept round slings or straps
- large block diameter (>10 times the cable diameter)
- Safety factor 2.5 (ground traction) / 5-fold (hoist)
- all spares available individually from stock

Article no.	Type	max. WLL cable-ø at 180° ground traction / (hoist)	max. WLL bolt ground traction / (hoist)	max. cable-ø	ø-Roller	Weight	Cable Speed	CHF EUR
34.600TR	10 t	10 t / (5 t)	20 t / (10 t)	14 mm	ø 180 mm	6.70 kg	 	1'439.00 1'515.00
34.100TR	16 t	16 t / (8 t)	32 t / (16 t)	16 mm	ø 240 mm	11.00 kg	 	2'108.00 2'219.00

Triple Pulley Blocks with mounting bracket

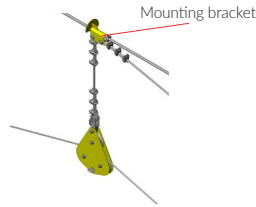

The triple pulley blocks are suspended on the terminal mast or on the skyline to guide the mainline. In order to guarantee correct winding onto the winch drum, the roller must be placed at least 30 times the drum width away from the cable winch. If the cable winch is closer to the terminal mast, the triple pulley block is hung onto the skyline and can be anchored on the ground.

Article no.	Type	Mainline Cable-ø	Weight	CHF	EUR
9.250_240	2.5	12 mm	24.80 kg	2'488.00	2'619.00
9.300_240	5	16 mm	34.80 kg	3'772.00	3'971.00
9.400_440	10	22 mm	51.00 kg	8'056.00	8'480.00
9.240	Mounting bracket, individual type 2.5 / type 5		2.80 kg	320.00	337.00

Automatic cable deflection roller

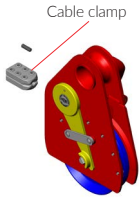

The automatically opening cable deflection roller permits loads to be pulled around obstacles without stopping. The automatic deflection roller opens as soon as the hook / spindle heads or cable clamp hits against the shift fork. This saves a laborious manual unclipping of the roller.

The roller is available for load capacities of 2.5 and 5 tonnes and may only be used for ground traction work. Do not exceed the max. cable tractive force, especially in operation with tractor winches.

Article no.	Type	Roller-ø	Max. WLL traction on the bolt	Max. WLL cable pull at 180°	Cable-ø up to max.	Weight	CHF	EUR
10.200H_250	2.5	240 mm	5 t	2.5 t	12 mm	13.40 kg	2'150.00	2'264.00
10.250	Cable clamp 2.5				12 mm	0.45 kg	123.00	130.00
10.300	5	320 mm	10 t	5 t	16 mm	44.50 kg	5'126.00	5'396.00

Mainline idler pulley



The mainline idler pulley is used where the mainline scrapes heavily against the ground. Heavy wear and tear on the mainline can thus be avoided.

The mainline idler pulley is suspended with two arrestor cables on the supports and supporting mast and fixed or bolted to the ground with an anchor cable.

Article no.	Type	Roller-ø	Weight	CHF	EUR
9.100	2. 5 / 5	173 mm	16.20 kg	2'111.00	2'223.00
9.100H	2.5 / 5, hardened roller	173 mm	16.20 kg	2'177.00	2'292.00
9.700	10	280 mm	100.00 kg	11'659.00	12'273.00

Double deflection roller



The double deflection roller is mainly used for circular drive cableways for support of circulating or return cables. The two rollers ensure stable and smooth guiding of the cable.

Art. no.	Roller-ø version	Material Plate Roller	Max. WLL traction on the bolt	Max. cable pull at 180°	Weight	CHF	EUR
34.6200	ø 180 mm Standard	Steel Steel	4'000 kg	ø 11 mm 30 mm	15.50 kg	1'583.00	2'223.00
34.1200	ø 240 mm Standard / Typ 2.5	Steel Steel	5'000 kg	ø 12 mm 36 mm	approx. 25 kg	on request	on request
34.2200	ø 320 mm Standard / Typ 5	Steel Steel	10'000 kg	ø 16 mm 50 mm	approx. 65 kg	on request	on request

Cable carrier with brake

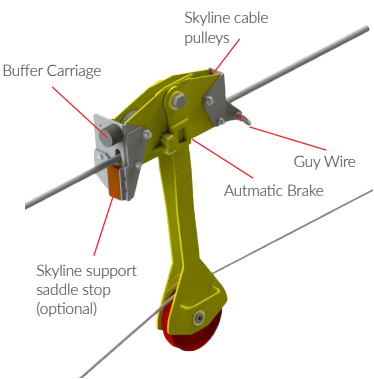

The cable carrier holds the mainline up and close to the skyline so that wood can be safely transported away at the landing place. Thus the danger of the traction cable getting caught on the wood or on the gripper / processor of the excavator can be excluded. It is braced laterally from above and the automatic brake prevents running back when the traction cable pulley is under load. In addition there is a collision protection for the cable carrier, with which the cable carrier strikes the Wyssen skyline support saddle and is stopped. This enables the cable carrier to run with the carriage down to the 1st support (top support) and stops there as a high mounting for the skyline.

Article no.	Type	Weight	CHF	EUR
11.6010	Cable Carrier with brake (without skyline cable pulleys / buffers, specify separately when ordering)	38.00 kg	3'572.00	3'760.00
11.6300DXX	Skyline cable pulleys complete (2 pcs. included) (specify suspension cable diameter when ordering)	7.40 kg	810.00	854.00
11.6600-XX	Buffer carriage Wyssen (Specify carriage type when ordering)*	10.00 kg	836.00	880.00
11.6625	Support saddle stop	3.70 kg	405.00	427.00

*Buffers for third-party carriages must be adjusted by the customer.

Traversable cable carriers

The traversable cable carriers have widely different applications and are mainly used to keep the mainline up high. E.g. in the case of long spans sections or when crossing obstacles and forestry tracks, the chassis and loading platform or carriage can be driven through. The traversability can be adjusted as desired. The cable carrier is clamped to the skyline under spring pressure and available with either normal or hardened steel rollers furnished with ball-bearings.



Article no.	Type	Length	Weight	CHF	EUR
11.2000A	Cable carrier type 2.5 traversable for HY-3/HY-4	7.5 m	96.00 kg	6'242.00	6'571.00
11.2000AH	Cable carrier type 2.5 traversable for HY-3/HY-4, with hardened centre ring	7.5 m	96.00 kg	6'301.00	6'633.00
11.3000	Cable carrier type 5 traversable for HY-2, HY-3, HY- 4, SP, U	7.5 m	118.00 kg	7'252.00	7'634.00
11.3000H	Cable carrier type 5 traversable for HY-2, HY-3, HY- 4, SP, U	7.5 m	118.00 kg	7'313.00	7'698.00
11.3020	Vertical tube special type 2.5/type 5, instead of cable sling			859.00	905.00
11.4000	Cable carrier type 10 traversable for (skyline ø 46 mm)	6 m	240.00 kg	14'399.00	15'157.00

Terminal mast block with clamp

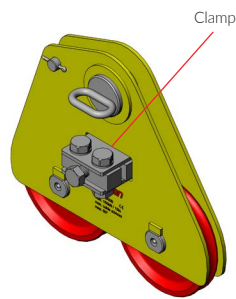

The terminal mast block is used on the side of the skyline tension, so that the skyline slips optimally through the terminal mast when under tension. The skyline must not move on the rollers when the installation is in operation. If such a risk exists, the skyline is fixed after assembly and running in of the installation with the cable clamp to the roller pair, so that a cable breakage can be prevented. If the skyline is fixed with a cable clamp, the terminal mast block must be suspended on a correspondingly long cable sling.

Article no.	Type for carriage	Max. cable-ø Max. cable deflection Max. WLL	Weight	CHF	EUR
27.300B	2.5, incl. clamp HY-2, HY-4, SP, Univ., LW 2.5 t	24 mm 60° 15 t	23.60 kg	1'586.00	1'670.00
27.400A	5, incl. clamp HY-7, MSK 2, SP, Univ., LW 5 t	32 mm 60° 25 t	46.75 kg	2'630.00	2'769.00
27.500A	10, incl. clamp HY-7, MSK 2, LW 10 t	46 mm 60 ° 50 t	100.00 kg	6'517.00	6'860.00

Clamp for terminal mast block

Article no.	Type	Weight	CHF	EUR
27.320	Clamp assembled type 2.5, ø 24 mm	3.24 kg	323.00	340.00
27.420	Clamp assembled type 5, ø 32 mm	7.12 kg	414.00	436.00

With few exceptions the clamp must always be assembled for safety reasons.

Spar tree saddle



The spar tree saddle serves to hold up the skyline at the terminal mast.

It is used on the side where the skyline is anchored only and not under tension.

Compared to conventional skyline support saddles, the spar tree saddle features are the light weight and cable deflections up to 60°.

Article no.	Type for carriage	Max. cable-ø Max. cable deflection Max. WLL	Weight	CHF	EUR
27.800	2.5 HY-2, HY-4, SP, Univ., LW 2.5 t	28 mm 60° 15 t	7.60 kg	871.00	917.00
27.900	5 HY-7, MSK 2, SP, Univ., LW 5 t	32 mm 60° 22 t	19.80 kg	1'254.00	1'320.00
27.1000	10 HY-7, MSK 2, LW 10 t	46 mm 60 ° 50 t	81.10 kg	on request	on request



Support saddles

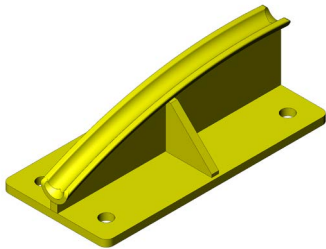

The support saddle primarily serves as a skyline support over rock or concrete anchors, so that damage to the cable is prevented.

Article no.	Type for carriage	Max. Cable-ø Max. cable deflection	Weight	CHF	EUR
29.700	2.5 HY-2, HY-4, SP, Univ., LW 2.5 t	24 mm 30°	6.50 kg	757.00	797.00
29.600	5 HY-7, MSK 2, SP, Univ., LW 5 t	34 mm 30°	12.60 kg	1'133.00	1'193.00
29.500	10 HY-7, MSK 2, LW 10 t	46 mm 30 °	65.00 kg	3'258.00	3'430.00



Skyline support saddle type 2.5



The tried and tested Wyssen skyline support saddle has been used for several years worldwide. It has excelled through its extreme high strength and at the same time its light weight.

The skyline support saddle type 2.5 is designed for a maximum WLL saddle pressure of 6 t (safety factor of 4) and a max. cable deflection of 30°, which can be used for carriages 2.5 t, HY-2, HY-3, HY-4, slack-puller and the universal carriage. If the saddle pressure is greater or the cable deflection is more than 30° two saddles must be used together with the Wyssen support balance.

Article no.	Type	Max. cable-ø	Weight	CHF	EUR
7.1000D16	2.5	16 mm	23.00 kg	2'080.00	2'190.00
7.1000D18	2.5	18 mm	23.00 kg	2'080.00	2'190.00
7.1000D20	2.5	20 mm	23.00 kg	2'080.00	2'190.00
7.1000D24	2.5	24 mm	23.00 kg	2'080.00	2'190.00
7.1000D28	2.5	28 mm	23.00 kg	2'080.00	2'190.00
7.1000D32	2.5	32 mm	23.00 kg	2'080.00	2'190.00

Skyline support saddle type 5

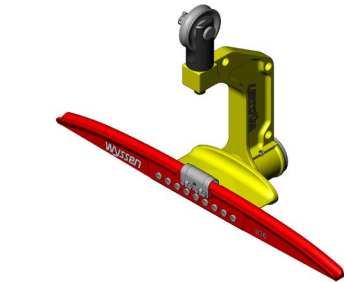

The Wyssen skyline support saddle type 5 has been developed for higher cable tensions and load capacities. It functions up to a maximum WLL support pressure of 12 t (safety factor of 5) and a maximum cable deflection of 30°. The type 5 saddle can be used for the 5 t and HY-7 carriages, and for the MSK 2 motorised skyline crane.

For higher loads two saddles may also be used with the Wyssen support balance.

Article no.	Type	Max. cable-ø	Weight	CHF	EUR
7.2000D32	5	32 mm	80.00 kg	8'557.00	9'008.00
7.2000D34	5	34 mm	80.00 kg	8'557.00	9'008.00
7.2000D36	5	36 mm	80.00 kg	8'557.00	9'008.00
7.2000D38	5	38 mm	80.00 kg	8'557.00	9'008.00
7.2000D40	5	40 mm	80.00 kg	8'557.00	9'008.00
7.2000D44	5	44 mm	80.00 kg	8'557.00	9'008.00

Skyline support saddles for cableways with higher load capacities are available on request.

Special shakles

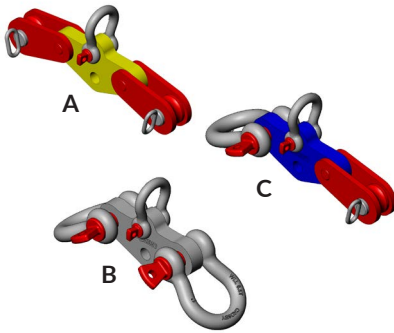

The special shackle is assembled on the clamp of the Wyssen skyline support saddle and is used for securing the raising and pulling cables and also tree slings, which are simply assembled and prepared on the ground. The skyline support saddle can subsequently be raised together with the cables, fixed around the tree and then pulled forward. The articulated shackle greatly facilitates skyline support saddle assembly of supports. There is also a special version for nylon ropes and nylon slings.

Article no.	Type - guy line / pre-pulling cable	Weight	CHF	EUR
7.1100	(A) 2.5 - steel / steel	6.68 kg	765.00	806.00
7.1100NN	(B) 2.5 - nylon / nylon with 2 pcs shakle	7.60 kg	296.00	312.00
7.1100NS	(C) 2.5 - nylon / steel with 1 pcs shakle	7.10 kg	477.00	503.00
7.2100	(A) 5 - steel / steel	18.70 kg	1'611.00	1'696.00

Accessories for the skyline support saddle



Curve saddles are also available for the Wyssen skyline support saddles type 2.5 and type 5, which depending on the carriage type and situation can handle curves up to a maximum of 7°.

For right-handed curves the required clamping yoke must be used. In addition there is also a type 2.5 hold-down saddle with which the skyline can be slightly pulled down.

Article no.	Type	Weight	CHF	EUR
7.1010	Curve saddle type 2.5 (main crosspiece only with brackets)	11.40 kg	3'088.00	3'251.00
7.1011	Curve saddle type 5 (main crosspiece only with brackets)	20.00 kg	4'288.00	4'514.00

Article no.	Type	Weight	CHF	EUR
7.1013	Clamping yoke for skyline support saddle type 2.5 (set) for a right-hand curve (new red for all Wyssen carriages)	28.50 kg	980.00	1'032.00

Article no.	Type	Weight	CHF	EUR
7.1500D24	Hold-down saddle type 2.5 special	59.00 kg	3'635.00	3'827.00

Mainline cable pulley blocks

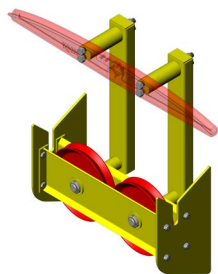

The function of the mainline cable pulley blocks is to position the mainline high up on the skyline support saddle. This can simply be attached to the skyline support saddle or taken away. The 2 or 4 roller block enables the mainline run through smoothly, thus reducing wear. The mainline cable pulley blocks can be used with the suitable drive units (e.g. supply cableways to Alpine farms).

Article no.	Type	Weight	CHF	EUR
7.1700	2 rollers for the skyline support saddle type 2.5 (to 7.1000)	60.90 kg	2'742.00	2'887.00
7.2700	4 rollers for the skyline support saddle type 5 (to 7.2000)	155.00 kg	5'061.00	5'328.00

The skyline support saddle is not included in delivery.

Curve saddle (on request)

Safe and gentle on the cable through every curve

The specially developed Wyssen skyline support saddle has a modular design and can be used for left and right curves up to 20°. Only the central main bar (also known as the “sword”) needs to be adjusted to the respective curve angle. In combination with the Wyssen curve running gear with integrated sheave guards, safe and reliable crossing is guaranteed. Thanks to large roller diameters and several deflection rollers for the mainline cable, the skyline support saddle is particularly gentle on the cable and it is recognized for its durability and efficiency.

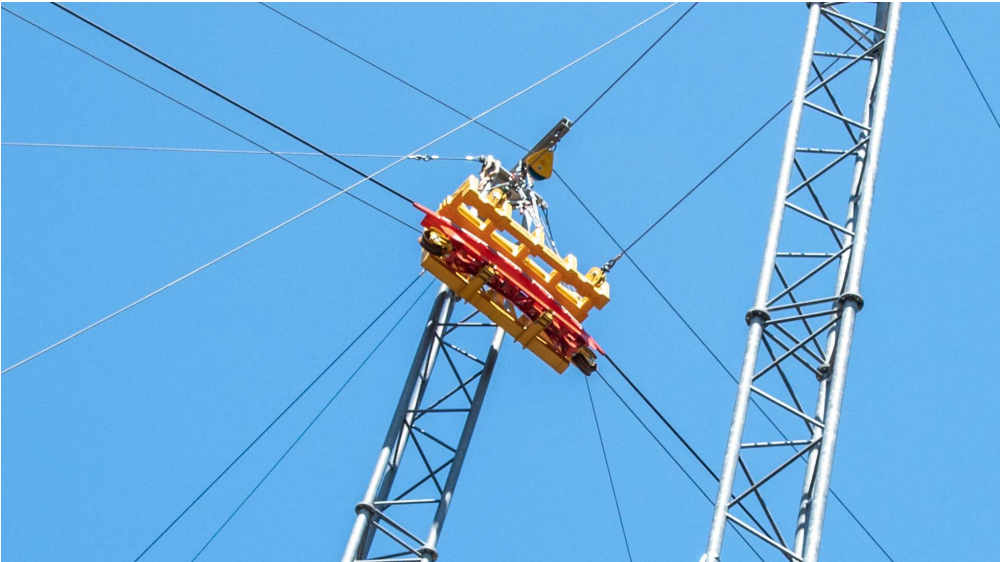

Support balances

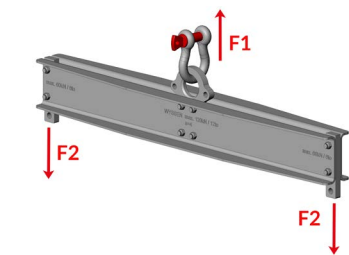

If the support balances pressure is too high or the cable deflection is too large, these may be distributed over two skyline support saddles using support balances, so that extreme loading of the skyline support saddles can be prevented. The support balance with two skyline support saddles also leads to a gentler passage over the supports, which is why to skyline support saddles can also be traversed faster.

Article no.	Type	Max. WLL		Hole distance	Weight	CHF	EUR
		F1	F2				
7.1200V	for saddle type 2.5 with shakles 1 1/4"	12t	6t	1'450 mm	65.00 kg	1'867.00	1'966.00
7.1350	for saddle type 5 with shakles 2"	32t	16t	1'800 mm	291.00 kg	4'110.00	4'327.00
7.1350A	for terminal mast block type 5 with shakles 2", ear - hole ø 110 mm	32t	16t	1'800 mm	294.00 kg	4'110.00	4'327.00

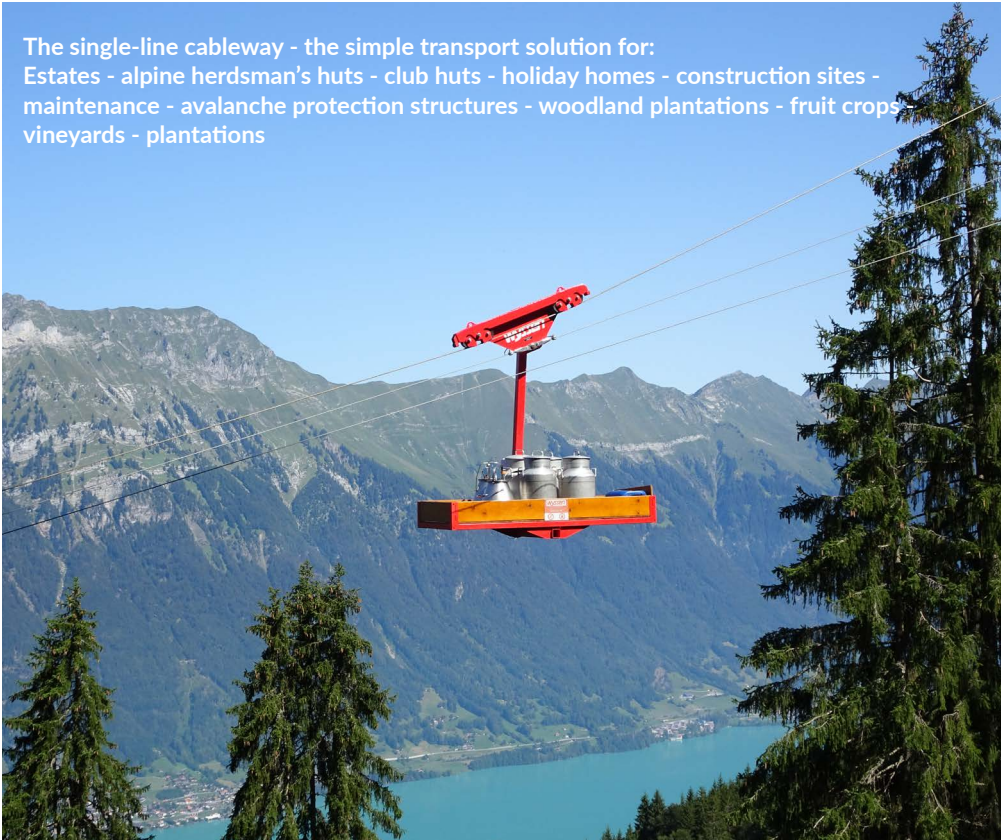

The single-line cableway - the simple transport solution for:
Estates - alpine herdsman's huts - club huts - holiday homes - construction sites -
maintenance - avalanche protection structures - woodland plantations - fruit crops -
vineyards - plantations

DQT-Support material

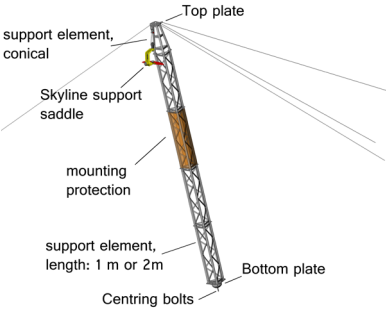

With Wyssens' DQT support elements (width across corners 0.5 m), supports (single to triple) can be modularly assembled in different heights. You can also order complete supports from us in the desired height including standard anchoring materials.

When constructing a support, please observe the respective approved support pressure. Please observe the operating manual! The Wyssen DQT elements must not be used / combined together with similar (even supposedly compatible) elements!

Further DQT material and larger elements (width across corners 1.0 m) are available on request.

DQT-Support elements

Article no.	Type	Weight	CHF	EUR
29.1500-2	DQT Steel grid support element, length 2 m	57.00 kg	811.00	854.00
29.1500-1	DQT Steel grid support element, length 1 m	37.00 kg	559.00	589.00
29.1500-1K	DQT Steel grid support element, length 1 m (conical)	33.00 kg	580.00	611.00

Single DQT support

Article no.	Type	Weight	CHF	EUR
29.1017	Top plate for a single DQT support (conical)	19.20 kg	1'055.00	1'111.00
29.1010	Bottom plate for a single DQT support (without centring bolts)	44.23 kg	1'795.00	1'890.00
29.1011	Centring bolts for the bottom plate of a single DQT support	2.37 kg	183.00	193.00
29.1030	Intermediate plate for single DQT support	20.00 kg	300.00	316.00
29.1520	Sling mounting protection	2.75 kg	645.00	679.00

Double DQT support

Article no.	Type	Weight	CHF	EUR
29.1640	Top plate for a double DQT support (conical)	93.00 kg	3'125.00	3'290.00
29.1651	Bottom plate for a double DQT support (conical)	49.00 kg	2'605.00	2'743.00
29.1652	Centring bolts for the bottom plate of a double DQT support (conical)	4.00 kg	238.00	251.00
29.1631	Cap for a double to quadruple DQT support	0.70 kg	28.70	30.30
29.1630	Connecting strap for a double to quadruple DQT support	2.10 kg	48.90	51.50
29.1632-2	Intermediate plate for double DQT support	12.00 kg	331.00	349.00

Triple DQT support

Article no.	Type	Weight	CHF	EUR
29.1620	Top plate for a triple DQT support (conical)	177.33 kg	3'557.00	3'745.00
29.1600	Wyssen bottom piece for a triple DQT support (conical)	157.00 kg	4'195.00	4'416.00
29.1601	Centring bolts for bottom piece of triple DQT support (conical)	6.60 kg	190.00	200.00
29.1631	Cap for a double to quadruple DQT support	0.70 kg	28.70	30.30
29.1630	Connecting strap for a double to quadruple DQT support	2.10 kg	48.90	51.50
29.1632-3	Intermediate plate for triple DQT-support	42.35 kg	602.00	634.00

A-DQT-supports

Article no.	Type	Weight	CHF	EUR
29.1006	Top plate for support yoke for DQT A-support	42.00 kg	1'489.00	1'568.00
29.1012	Top plate with hinge for A support (conical)	40.00 kg	1'748.00	1'840.00
29.1010	Bottom plate for a single DQT support (without centring bolts)	44.23 kg	1'795.00	1'890.00
29.1011	Centring bolts for the bottom plate of a single DQT support	2.37 kg	183.00	193.00

On request, A supports in double and triple versions as well as various other versions are available.

Screw / Washer / Nut

Article no.	Type	Weight	CHF for 1 pc CHF for 50 pcs	EUR for 1 pc EUR for 50 pcs
Fits to all DQT - elementens				
4151M14X050	Hex Cap Screw ISO 4014 M14X050	0.08 kg	1.80	1.90
			1.60	1.70
4623M14	Spring Lock Washer DIN 128 A Vossloh M14	0.01 kg	0.40	0.50
			0.30	0.40
4513M14	Hexagon Nut ISO 4032 M14	0.02 kg	0.70	0.80
			0.60	0.70



Cable slings

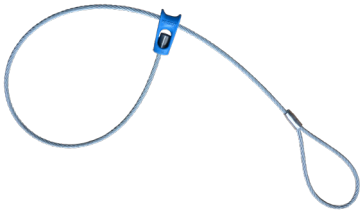

Cable slings with sling hooks (cable construction 6x25FW+WC/galvanised), with a press sleeve on one side and slings for the choker ring on the other side, are available with 11 mm and 13 mm diameters in various lengths. Wyssen sling hooks are tested for cracks and are made out of high-quality material, that depending on the length of the sling are in each case indicated in the appropriate colour. On request we can manufacture choker slings in other lengths for you.

Article no.	Type - ø x length	WLL (2-fold safety*)	Weight	CHF for 1 pc CHF for 10 pcs CHF for 20 pcs	EUR for 1 pc EUR for 10 pcs EUR for 20 pcs
39.300D11B	Blue - ø 11 x 2.0 m	3.1 t	1.90 kg	95.00 85.50 78.80	100.00 90.00 83.00
39.300D11G	Yellow - ø 11 x 2.5 m	3.1 t	2.20 kg	97.90 88.30 81.30	104.00 93.00 85.60
39.300D11S	Silver - ø 11 x 3.0 m	3.1 t	2.50 kg	102.00 90.90 84.40	108.00 95.70 88.90
39.300D11R	Red - ø 11 x 3.5 m	3.1 t	2.80 kg	105.00 93.70 82.60	111.00 98.70 87.00

Article no.	Type - ø x length	WLL (2-fold safety*)	Weight	CHF for 1 pc CHF for 10 pcs CHF for 20 pcs	EUR for 1 pc EUR for 10 pcs EUR for 20 pcs
39.300D13B	Blue - ø 13 x 2.0 m	4.3 t	2.50 kg	97.90 89.70 81.30	97.90 89.70 81.30
39.300D13G	Yellow - ø 13 x 2.5 m	4.3 t	2.80 kg	102.00 92.30 84.40	102.00 92.30 84.40
39.300D13S	Silver - ø 13 x 3.0 m	4.3 t	3.10 kg	105.00 95.00 88.20	105.00 95.00 88.20
39.300D13R	Red - ø 13 x 3.5 m	4.3 t	3.40 kg	109.00 97.90 90.90	109.00 97.90 90.90

For exchange slings we grant a discount (39.300AUST), provided your sling hooks can be further utilised.

***Double safety is required as a slinging device for forest cableways.**

Choker ring



The choker ring enables scattered tree trunks to be collected for loading in one operation by pulling sideways. The high-strength hardened and extremely light Wyssen choker ring can be quickly mounted both with and without tools. The highest degree of safety is guaranteed by the large wrap of the ring, which reduces cable wear and in addition in the case of ring breakage, the load remains hanging in the sling on the end / mainline. Choker rings can be used for cable slings \varnothing 11 - 13 mm.

Article no.	Type	Weight	CHF for 1 pc CHF for 10 pcs CHF for 20 pcs	EUR for 1 pc EUR for 10 pcs EUR for 20 pcs
31.3420	\varnothing 11 - 13 mm	1.25 kg	132.00 121.00 114.00	139.00 128.00 120.00

Choker slings



Choker slings with sling hooks (cable construction 6x25FW+WC/galvanised), with a stud on both ends, are available with 11 mm and 13 mm diameters in various lengths. Wyssen sling hooks are tested for cracks and are made out of high-quality material that depending on the length of the sling is colour-coded in the corresponding colour. On request we can manufacture choker slings in other lengths for you.

Article no.	Typ - \varnothing x length	WLL (2-fold safety*)	Weight	CHF for 1 pc CHF for 10 pcs CHF for 20 pcs	EUR for 1 pc EUR for 10 pcs EUR for 20 pcs
39.400D11B	Blue - \varnothing 11 x 1.75 m	3.1 t	1.70 kg	93.70 84.40 77.40	98.70 88.90 81.50
39.400D11G	Yellow - \varnothing 11 x 2.0 m	3.1 t	1.80 kg	95.00 85.50 78.80	100.00 90.00 83.00
39.400D11S	Silver - \varnothing 11 x 2.25 m	3.1 t	2.00 kg	96.30 88.20 80.20	102.00 92.90 84.50
39.400D11R	Red - \varnothing 11 x 2.5 m	3.1 t	2.10 kg	97.90 89.70 81.30	104.00 94.50 85.60

*Double safety is required as a slinging device for forest cableways.

Cable sling with sliding hook



Cable slings with sling hooks (cable construction 6x36WS+FC/ galvanised) at one end with a loop and thimble to clip into the sliding hook when wrapping round the tree and at the other end a loop for clipping into the skyline support saddle, are used for rapid and safe suspension of the skyline support saddle onto tree supports. On request we can also manufacture cable slings in other lengths for you up to a max. ø 24 mm.

***4-fold safety is required when used as skyline support saddle straps.**

Article no.	ø x length	WLL (4-fold safety*)	Weight	CHF	EUR
39.500D20-2	ø 20 x 2.0 m	5.8 t	6.60 kg	193.00	204.00
39.500D20-2.5	ø 20 x 2.5 m	5.8 t	7.20 kg	199.00	210.00
39.500D20-3	ø 20 x 3.0 m	5.8 t	8.00 kg	203.00	214.00
39.500D20-3.5	ø 20 x 3.5 m	5.8 t	8.80 kg	208.00	219.00
39.500D22-2.5	ø 22 x 2.5 m	7.0 t	8.30 kg	274.00	289.00
39.500D22-3.5	ø 22 x 3.5 m	7.0 t	10.10 kg	283.00	298.00
39.500D24-2.5	ø 24 x 2.5 m	8.3 t	10.20 kg	303.00	319.00
39.500D24-3.5	ø 24 x 3.5 m	8.3 t	12.30 kg	317.00	334.00

Additional diameters and lengths on request. For exchange slings we grant a discount (39.500AUST), provided your sliding hooks can be further utilised.

Pre-fabricated steel wire cables



On request we can manufacture various slings and rope slings in a wide variety of dimensions.

Sling hooks (cable lock, slide)



Sling hook for cable loop and choker sling, made of high-strength heat-treated steel, tested for cracks, for cable ø 11 - 13 mm. Available in various surface treatments (add the code to the item number: red=-R, blue=-B, yellow=-G, silver=-S, rust protection=-RS) Prices vary depending on surface treatment and quantity.

Article no.	for cable-ø	Weight	CHF	EUR
39.100A-X	11 - 13 mm	0.56 kg	on request	on request

Wire rope slings

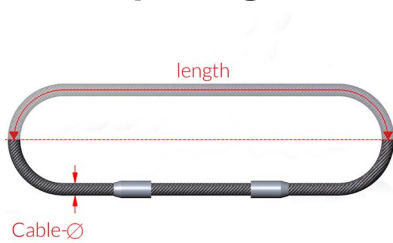

The continuous wire rope slings (cable construction 6x36WS+FC/galvanised) is primarily used for tree and ground anchoring (dead man) and for suspending skyline support saddles. The automatic skyline clamp, straining clamps and the skyline support saddle can be easily and safely mounted.

***Observe safety factor depending on application!**

Article no.	Type for	Cable-ø	Length	*Breaking Load	Weight	CHF	EUR
39.600D18-02	support saddle 2.5	18 mm	1 m	38.4 t	3.10 kg	99.40	105.00
39.600D18-03	support saddle 2.5	18 mm	1.5 m	38.4 t	4.40 kg	110.00	116.00
39.600D18-04	support saddle 2.5	18 mm	2 m	38.4 t	5.60 kg	119.00	126.00
39.600D18-06	support saddle 2.5	18 mm	3 m	38.4 t	8.10 kg	135.00	143.00
39.600D18-08	support saddle 2.5	18 mm	4 m	38.4 t	10.50 kg	152.00	160.00
39.600D18-12	tree anchor 2.5	18 mm	6 m	38.4 t	15.40 kg	186.00	196.00
39.600D18-18	tree anchor 2.5	18 mm	9 m	38.4 t	22.80 kg	237.00	250.00
39.600D18-25	ground anchor 2.5	18 mm	12.5 m	38.4 t	31.40 kg	297.00	313.00
39.600D20-04	support saddle 2.5	20 mm	2 m	47.4 t	7.00 kg	127.00	134.00
39.600D20-06	support saddle 2.5	20 mm	3 m	47.4 t	10.00 kg	145.00	153.00
39.600D20-14	tree anchor 2.5	20 mm	7 m	47.4 t	22.20 kg	215.00	227.00
39.600D20-25	ground anchor 2.5	20 mm	12.5 m	47.4 t	38.90 kg	311.00	328.00
39.600D22-02.5	support saddle 5	22 mm	1.25 m	57.5 t	5.90 kg	125.00	132.00
39.600D22-04	support saddle 5	22 mm	2 m	57.5 t	8.70 kg	141.00	149.00
39.600D22-08	support saddle 5	22 mm	4 m	57.5 t	16.10 kg	182.00	192.00
39.600D22-14	tree anchor 5	22 mm	7 m	57.5 t	27.10 kg	244.00	257.00
39.600D22-25	ground anchor 5	22 mm	12.5 m	57.5 t	47.30 kg	359.00	378.00
39.600D26-06	support saddle 5	26 mm	3 m	80.2 t	17.40 kg	274.00	289.00
39.600D26-09	support saddle 5	26 mm	4.5 m	80.2 t	25.10 kg	320.00	337.00
39.600D26-14	support saddle 5	26 mm	7 m	80.2 t	38.00 kg	404.00	426.00
39.600D28-04	support saddle 5	28 mm	2 m	93.1 t	13.90 kg	264.00	278.00
39.600D28-14	support saddle 5	28 mm	7 m	93.1 t	42.10 kg	437.00	460.00
39.600D28-25	ground anchor 5	28 mm	12.5 m	93.1 t	73.10 kg	595.00	627.00
39.600D30-3	support saddle	30 mm	1.5 m	106.8 t	17.20 kg	275.00	290.00
39.600D30-4.5	support saddle	30 mm	2.25 m	106.8 t	17.60 kg	290.00	306.00

On request we can also manufacture wire rope slings in other lengths and diameters for you.

Anchoring cables



Anchoring cables (guy line cable) are galvanised with a thimble or loop at one end are used for anchoring supports, cable winches, multiple tree anchors etc. These are available in different standard lengths and diameters as well as in other desired dimensions.

Article-no.	Type	Cable-ø	Length	Weight	CHF	EUR
39.620D12-20	with thimble and pressing	12 mm	20 m	10.00 kg	143.00	151.00
39.620D12-30	with thimble and pressing	12 mm	30 m	15.00 kg	202.00	213.00
39.620D12-40	with thimble and pressing	12 mm	40 m	20.00 kg	261.00	275.00
39.620D12-45	with thimble and pressing	12 mm	45 m	22.50 kg	291.00	307.00
39.620D12-50	with thimble and pressing	12 mm	50 m	25.00 kg	321.00	338.00
39.630D12-30	with loop and pressing	12 mm	30 m	15.00 kg	200.00	211.00
39.630D12-35	with loop and pressing	12 mm	35 m	18.00 kg	230.00	243.00
39.630D12-40	with loop and pressing	12 mm	40 m	20.00 kg	259.00	273.00
39.630D12-45	with loop and pressing	12 mm	45 m	23.00 kg	289.00	305.00
39.630D12-50	with loop and pressing	12 mm	50 m	25.00 kg	320.00	337.00
39.630D12-55	with loop and pressing	12 mm	55 m	28.00 kg	347.00	366.00
39.630D12-60	with loop and pressing	12 mm	60 m	30.00 kg	378.00	398.00
39.630D16-50	with loop and pressing	16 mm	50 m	45.00 kg	397.00	418.00
39.630D16-60	with loop and pressing	16 mm	60 m	54.00 kg	469.00	494.00
39.630D16-70	with loop and pressing	16 mm	70 m	63.00 kg	542.00	571.00
39.630D24-80	with loop and pressing	24 mm	80 m	170.00 kg	1'207.00	1'271.00

On request anchor cable extensions with loop or thimble on both sides are available.

We can also deliver every skyline and mainline for you. We will be pleased to send you our offer.

We also have a wide selection of used cables, just ask us or look at the current list on our website under www.wyssenseilbahnen.com/en/used-equipment/ (second-hand-market).

Cable reels



Cable reels made out of steel are available in two sizes and depending on the type are either galvanised or coated with a yellow rust protection. With every cable reel a reducing sleeve is included so that the hole diameter for the shaft can be reduced from 81 mm to 62 mm. The reels are also prepared for simple connection (tappet) for the Wyssen cable spool drive.

Article no.	Type	Reel-ø outer inner	Width outer inner	Weight	CHF	EUR
30.300SR	150 (Hole 81/62 mm)	1500 mm 700 mm	1122 mm 900 mm	215.00 kg	2'405.00	2'532.00
30.300S-170	170 (Hole 81/62 mm) galvanised	1700 mm 700 mm	1122 mm 900 mm	390.00 kg	2'708.00	2'851.00

Cable capacities of the cable reels

Cable-ø	Cable lengths for reel ø 1500 mm	Cable lengths for reel ø 1700 mm
14 mm	4750 m	6780 m
16 mm	3605 m	5120 m
18 mm	2895 m	4020 m
20 mm	2307 m	3325 m
22 mm	1814 m	2730 m
24 mm	1550 m	2210 m
25 mm	1507 m	2160 m
26 mm	1320 m	1940 m
27 mm	1287 m	1735 m
28 mm	1120 m	1700 m
29 mm	1092 m	1510 m
30 mm	942 m	1480 m
32 mm	901 m	1280 m
34 mm	753 m	1010 m
36 mm	724 m	947 m
38 mm	598 m	917 m
40 mm	577 m	777 m

The cable capacity is so calculated, that there is 7.5 cm free space on both sides between the cable on the outer diameter, so that it is still possible to roll the reel. On request we can also provide you with details about other cable diameters.

Cable spool drive

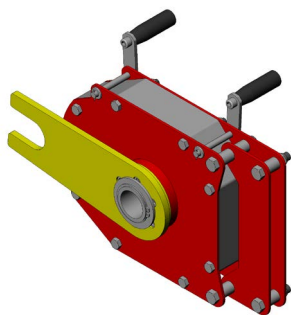

The Wyssen cable spool drive is a special device for quick and easy winding and unwinding of steel wire cables. The tractive force is approx. 500 kg and the speed of about 1.5 m/s for a cable layer of \varnothing 1 m. On account of its capacity and minimal weight, the capability is ideally suitable for mobile operation thanks to its quick and easy installation.

The cable spool drive can optionally be delivered with the cable winch W-10. The Wyssen hydraulic unit or with suitable hydraulic hose quick release connectors for your machine such as tractors, truck cranes etc.

Picture without accessories

Article no.	Type	Weight	CHF	EUR
30.2500	Hydraulic cable spool drive complete with accessories	94.00 kg	9'948.00	10'472.00
30.2700B	Hydraulic unit for cable spool drive 18 PS	183.00 kg	12'446.00	13'102.00
46.SKZB	Quick release coupling to W-10 for cable spool drive		513.00	540.00

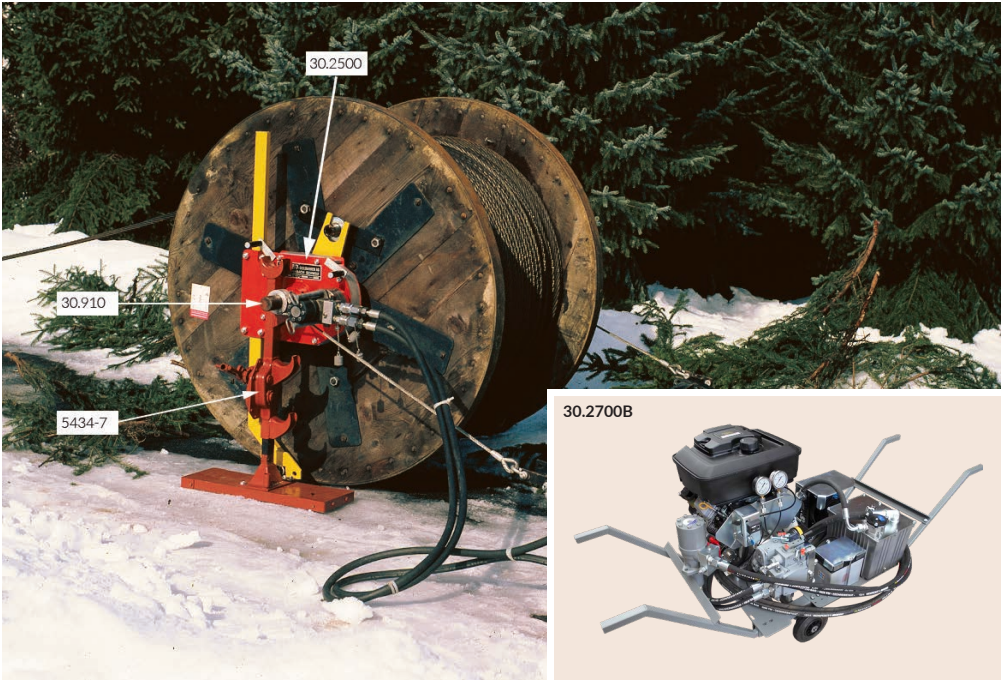

Cable spool jack



The “Swiss-Made” cable spool jack is used for lifting the cable drums (2 are needed) for winding and unwinding steel wire cables. The winches are characterised by their low eight and high load bearing capacity and also the large base plate, which prevents sliding or overturning. The cable spool jacks are equipped with solid ratchet - safety lever including an operating bar.

Article no.	Type	Lifting capacity per article	Spool ø min. - max.	Weight	CHF	EUR
5434-5	Cable spool jack Robor	5 t	500 - 2'400 mm	30.00 kg	1'290.00	1'358.00
5434-7	Cable spool jack Robor	7 t	600 - 2'400 mm	42.00 kg	1'946.00	2'049.00
5434-10	Cable spool jack Simplex	9 t	500 - 2'400 mm	on request	on request	on request

Shafts and sleeves



These can be raised using the cable spool jack with the suitable shaft for your cable reel. The shaft is made of high-strength steel to prevent strong deflection. In order to ensure that the cable reel turns perfectly, a sleeve is fitted over the shaft both to the left and right between the cable reel and the cable spool drive. Special dimensions are also available on request.

Article no.	Type	Diameter	Length	Weight	CHF	EUR
30.910	Shaft for cable reel	45 mm	1.8 m	22.50 kg	313.00	330.00
30.912	Sleeve for shaft 30.910			1.30 kg	44.90	47.30
30.920	Shaft for cable reel	55 mm	2.0 m	37.00 kg	455.00	479.00
30.922	Sleeve for shaft 30.920			1.60 kg	69.30	73.00
30.930	Shaft for cable reel	85 mm	2.5 m	112 kg	459.00	484.00

Foot-operated winch



The robust and very light Swiss-made foot-operated winch (rack and pinion jack) has a very high load bearing capacity and is used for every possible lifting and moving application of heavy loads. In the aerial cableway sector, the foot-operated winch is very often used for aligning cable winches.

The foot-operated winch is delivered with ratchet safety hand crank.

Article No.	Type	WLL	Weight	CHF	EUR
5433-1.5	Foot-operated winch	1.5 t	11.30 kg	526.00	554.00
5433-3	Foot-operated winch	3 t	14.50 kg	569.00	599.00
5433-5	Foot-operated winch	5 t	24.00 kg	711.00	749.00
5433-7	Foot-operated winch	7 t	27.00 kg	962.00	1'013.00
5433-10	Foot-operated winch	10 t	35.00 kg	1'181.00	1'244.00

Wyssen automatic clamp

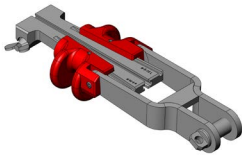

The automatic clamp with a single attachment bolt, self-clamping clamping jaws and a special groove is used for pulling, lifting and securing steel wire cables. In the aerial cableway sector, the automatic clamp is often used for pre-tensioning of support guys. Pre-clamping with wing nuts causes the clamps to slide automatically into the wedging, so that depending on the traction, the required clamping pressure is generated for a secure clamping. In case of impact, the cable is prevented from jumping out.

Article No.	Type	Max. WLL tension	for cable-ø	Weight	CHF	EUR
35.4100D-06	Single attachment bolt	1'600 kg	bis 6 mm	3.30 kg	1'050.00	1'106.00
35.4100D06-08	Single attachment bolt	1'600 kg	6 - 8 mm	3.30 kg	1'050.00	1'106.00
35.4100D08-10	Single attachment bolt	1'600 kg	8 - 10 mm	3.30 kg	1'050.00	1'106.00
35.4100D10-12	Single attachment bolt	1'600 kg	10 - 12 mm	3.30 kg	1'050.00	1'106.00
35.4008	Clamping jaw left	1'600 kg	by choice	0.40 kg	129.00	136.00
35.4009	Clamping jaw right	1'600 kg	by choice	0.40 kg	129.00	136.00

Article No.	Type	Max. WLL tension	for cable-ø	Weight	CHF	EUR
35.5100D12-15	Single attachment bolt	3'200 kg	12 - 15 mm	7.40 kg	1'850.00	1'948.00
35.5100D15-18	Single attachment bolt	3'200 kg	15 - 18 mm	7.40 kg	1'850.00	1'948.00
35.5008	Clamping jaw left	3'200 kg	by choice	1.02 kg	232.00	245.00
35.5009	Clamping jaw right	3'200 kg	by choice	1.04 kg	232.00	245.00

Wyssen automatic clamp (two attachment bolts)

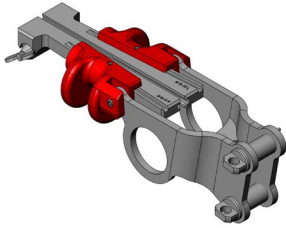

The automatic clamp with two attachment bolts is practically identical to the standard automatic clamp. This automatic clamp is equipped with two bolts and has additionally a hole in the bracket, through which a bar / piece of wood can be inserted to prevent twisting of the automatic clamp. One bolt is used as a fixation when tightening and with the other bolt a second fastening can be clipped in, so that the fixation of the tightening bolt can be easily released.

Article no.	Type	Max. WLL tension	für cable-ø	Weight	CHF	EUR
35.4000D-06	Double attachment bolts	1'600 kg	to 6 mm	3.70 kg	1'090.00	1'148.00
35.4000D06-08	Double attachment bolts	1'600 kg	6 - 8 mm	3.70 kg	1'090.00	1'148.00
35.4000D08-10	Double attachment bolts	1'600 kg	8 - 10 mm	3.70 kg	1'090.00	1'148.00
35.4000D10-12	Double attachment bolts	1'600 kg	10 - 12 mm	3.70 kg	1'090.00	1'148.00
35.4008	Clamping jaw left	1'600 kg	by choice	0.40 kg	129.00	136.00
35.4009	Clamping jaw right	1'600 kg	by choice	0.40 kg	129.00	136.00

Bugnard cable tensioning clamp



The Bugnard cable tensioning clamp with retaining spring is used for pulling, lifting and securing steel wire cables. This clamp made out of special steel and drop forged is parallel clamping with smooth clamping jaws with a V profile on the inside. Attention: The clamp may only be used for ground traction, since in case of impact, it could release from the cable.

Article no.	Type	Max. WLL tension	for cable-ø	Weight	CHF	EUR
5439D05.5-14	Bugnard	3'630 kg	5.5 - 14 mm	2.72 kg	503.00	530.00
5439D08-16	Bugnard	6'810 kg	8 - 16 mm	6.93 kg	1'110.00	1'169.00
5439D12-19	Bugnard	6'810 kg	13 - 19 mm	7.35 kg	1'079.00	1'136.00
5439D19-25	Bugnard	6'810 kg	19 - 25 mm	7.35 kg	1'081.00	1'138.00

Crosby wedge socket



The wedge socket functions as an end connection and as a fixation for steel wire cables. The dead end of the steel wire cable is secured in the wedge, in such a way that the wedge cannot be ejected or lost. The automatic clamp can be simply mounted and dismantled at any time and used further.

Article No.	Type	for cable-ø	Weight	CHF	EUR
5451D10	3/8"	9 - 10 mm	1.00 kg	124.00	131.00
5451D13	1/2"	11 - 13 mm	2.10 kg	174.00	184.00
5451D16	5/8"	14 - 16 mm	4.00 kg	248.00	262.00
5451D19	3/4"	18 - 19 mm	6.00 kg	300.00	316.00
5451D22	7/8"	20 - 22 mm	10.00 kg	368.00	388.00
5451D26	1"	24 - 26 mm	15.00 kg	485.00	511.00

Clamps

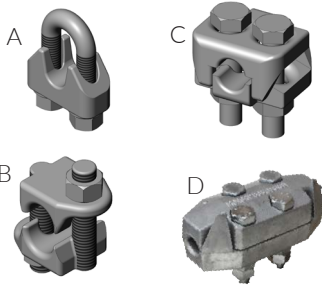

U-clamps, fist grip clamps and Duplex clamps are galvanised and are primarily used for loop connections. In each case the required cable diameter and the number of clamps per cable diameter should be noted (see table below). The clamps must be tightened under loading, since the cable becomes somewhat thinner under load and thus can become loose.

The clamp connections as a rule attain approx. 80% of the minimum cable breaking strength.

Article No.	Type (A)	Number per loop	Spanner width	for cable-ø	Weight	CHF	EUR
5442D05	U-Clamp	3	8	4 - 5 mm	0.02 kg	1.30	1.40
5442D06.5	U-Clamp	3	10	5.5 - 6.5 mm	0.04 kg	1.30	1.40
5442D08	U-Clamp	4	13	7 - 8 mm	0.08 kg	1.50	1.60
5442D10	U-Clamp	4	13	8.5 - 10 mm	0.09 kg	1.60	1.70
5442D12	U-Clamp	4	17	12 mm	0.28 kg	3.75	4.00
5442D14	U-Clamp	4	18	14 mm	0.28 kg	5.10	5.40
5442D16	U-Clamp	4	21	14 - 16 mm	0.43 kg	6.70	7.10
5442D19	U-Clamp	4	22	17 - 19 mm	0.49 kg	8.50	9.00
5442D22	U-Clamp	5	24	20 - 22 mm	0.68 kg	11.30	11.90
5442D26	U-Clamp	5	32	23 - 26 mm	1.17 kg	25.80	27.20
5442D30	U-Clamp	6	32	27 - 30 mm	1.40 kg	31.50	33.20
5442D34	U-Clamp	6	36	31 - 34 mm	2.13 kg	38.10	40.20
5442D40	U-Clamp	6	36	35 - 40 mm	2.68 kg	46.90	49.40

Article no.	Type (B)	Number per loop	Spanner width	for cable-ø	Weight	CHF	EUR
5443D10	Fist grip clamp	2	19	10 mm	0.18 kg	27.80	29.30
5443D11-13	Fist grip clamp	3	22	11 - 13 mm	0.32 kg	33.80	35.60
5443D14-16	Fist grip clamp	3	27	14 - 16 mm	0.45 kg	46.20	48.70
5443D18-20	Fist grip clamp	3	32	18 - 20 mm	0.79 kg	63.40	66.80
5443D22	Fist grip clamp	4	32	22 mm	1.02 kg	80.40	84.70
5443D24-26	Fist grip clamp	5	32	24 - 26 mm	1.36 kg	98.30	104.00
5443D28-30	Fist grip clamp	5	36	28 - 30 mm	1.81 kg	122.00	129.00
5443D32-34	Fist grip clamp	6	36	32 - 34 mm	1.81 kg	132.00	139.00
5443D36-40	Fist grip clamp	7	41	36 - 40 mm	3.18 kg	194.00	205.00

Article no.	Typ (C + D)	Number per loop	Spanner width	for cable-ø	Weight	CHF	EUR
5444D06	Duplex (C)	3	10	04 - 06 mm	0.09 kg	4.60	4.90
5444D09	Duplex (C)	4	13	07 - 09 mm	0.15 kg	8.10	8.60
5444D10	Duplex (C)	4	13	08 - 10 mm	0.23 kg	10.10	10.70
5444D12	Duplex (C)	4	17	09 - 13 mm	0.30 kg	12.40	13.10
5444D16	Duplex (C)	4	17/19	14 - 16 mm	0.55 kg	16.90	17.80
5444D20	Duplex (C)	4	22	16 - 20 mm	0.85 kg	30.10	31.70
5444D25	Duplex (C)	5	24	20 - 25 mm	1.34 kg	52.50	55.30
5444D20IG	IronGrip (D)	2	21	17 - 20 mm	1.18 kg	35.20	37.10
5444D25IG	IronGrip (D)	2	27	21 - 25 mm	2.80 kg	80.30	84.60
5444D34IG	IronGrip (D)	2	30	26 - 34 mm	7.70 kg	245.00	258.00



Shackles

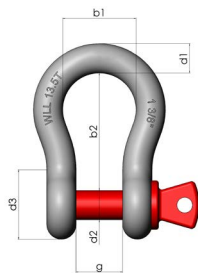

The forged and hardened shackles are known for their very high quality. Together with the suitable Wyssen anchor rollers the shackles are used for guy lines and anchor cables. (For suitable anchor rollers see page 31)

Details such as allowed loading, size, manufacturer's name and CE sign are marked on the loop.

Article no.	Load capacity kg	Type	b1 mm	b2 mm	d1 ø in mm	d2 ø in mm	d3 ø in mm	g mm	Weight	CHF	EUR
5445-0.5	500	1/4"	19.8	28.7	6.35	7.87	15.5	11.9	0.05 kg	2.20	2.40
5445-1	1'000	3/8"	26.2	36.6	9.65	11.2	23.1	16.8	0.14 kg	3.50	3.70
5445-1.5	1'500	7/16"	29.5	42.9	11.2	12.7	26.9	19.0	0.17 kg	3.90	4.20
5445-2	2'000	1/2"	33.3	47.8	12.7	16.0	30.2	20.6	0.29 kg	5.10	5.40
5445-3.25	3'250	5/8"	42.9	60.5	17.5	19.1	38.1	26.9	0.63 kg	6.90	7.30
5445-4.75	4'750	3/4"	51.0	71.5	20.6	22.4	46.0	31.8	1.02 kg	8.80	9.30
5445-6.5	6'500	7/8"	58.0	84.0	24.6	25.4	53.0	36.6	1.53 kg	12.70	13.40
5445-8.5	8'500	1"	68.5	95.5	26.9	28.7	60.5	42.9	2.41 kg	18.90	19.90
5445-9.5	9'500	1 1/8"	74.0	108	31.8	31.8	68.5	46.0	3.09 kg	24.70	26.00
5445-12	12'000	1 1/4"	82.5	119	35.1	35.1	76.0	51.5	4.31 kg	34.70	36.60
5445-13.5	13'500	1 3/8"	92.0	133	38.1	38.1	84.0	57.0	6.01 kg	47.90	50.50
5445-17	17'000	1 1/2"	98.5	146	41.2	41.4	92.0	60.5	7.80 kg	60.60	63.80
5445-25	25'000	1 3/4"	127	178	57.0	51.0	106	73.0	13.80 kg	101.00	107.00
5445-35	35'000	2"	146	197	61.0	57.0	122	82.5	20.40 kg	151.00	159.00
5445-55	55'000	2 1/2"	184	267	79.5	69.9	148	105	38.90 kg	on request	on request

Secure shackles must be used for permanent installations!

Aluminium anchor roller for shackles

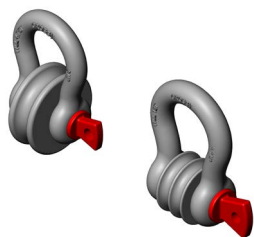

The aluminium anchor rollers are used for fastening steel wire cables, such as anchor cables, guy wires and skylines. The roller size is matched to the cable diameter and protects the cable from wear and prevents cable breakage. 2-groove anchor rollers can be used with round slings. For \varnothing 12 mm and \varnothing 16 mm it is also possible to use the appropriate shackles with 2 rollers, so that two loops can be tensioned independently.

Article no.	Type	for cable- \varnothing	for shackle	Weight	CHF	EUR
36.803	1-groove	6 mm	1/4"	0.02 kg	20.70	21.80
36.804	1-groove	9.5 - 10.5 mm	1/2"	0.07 kg	28.70	30.30
36.805	1-groove	9.5 - 12 mm	5/8"	0.14 kg	35.30	37.20
36.807	1-groove with 2 rollers*	9.5 - 12 mm	3/4"	0.09 kg	49.20	51.80
36.809	1-groove	16 mm	3/4"	0.31 kg	73.70	77.60
36.810	1-groove with 2 rollers*	16 mm	7/8"	0.14 kg	81.50	85.80
36.812	1-groove	18 mm	7/8"	0.40 kg	87.10	91.70
36.813	1-groove	18 mm	1"	0.50 kg	92.30	97.20
36.814	1-groove	22 mm	1 1/8"	0.83 kg	111.00	117.00
36.815	2-groove	18 mm	1 1/4"	0.53 kg	130.00	137.00
36.817	1-groove	26 mm	1 3/8"	1.79 kg	160.00	169.00
36.818	1-groove	22 mm	1"	0.60 kg	119.00	126.00
36.819	1-groove	26 mm	1 1/2"	0.98 kg	136.00	144.00
36.820	2-groove	22 mm	1 1/2"	0.94 kg	157.00	166.00
36.825	2-groove	22 mm	1 3/4"	0.98 kg	208.00	219.00
36.826	1-groove	27 - 30 mm	1 3/4"	1.20 kg	182.00	192.00
36.827	1-groove	24 mm	1 1/4"	0.82 kg	132.00	139.00
36.829D26	1-groove	26 mm	1 3/4"	2.67 kg	268.00	283.00
36.829D32	1-groove	32 mm	1 3/4"	2.67 kg	268.00	283.00

*2 pieces are needed per shackle!

Other anchor rollers on request.

Oval ring

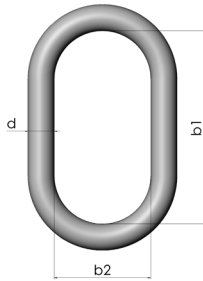

The lacquered quality Crosby-Oval-Rings are predominantly used for single and double strand wire rope slings. For three and four-strand lifting accessories three-piece ring sets must be used, which you can obtain from on request.

(see page 20, pre-fabricated steel wire cables)

Article no.	Type	b1 mm	b2 mm	d ø in mm	WLL	Weight	CHF	EUR
5454-01.4	Oval-Ring	115	65	13	1.4 t	0.40 kg	14.20	15.00
5454-02.0	Oval-Ring	130	65	16	2.0 t	0.68 kg	18.50	19.50
5454-04.0	Oval-Ring	180	90	20	4.0 t	1.45 kg	34.60	36.50
5454-06.3	Oval-Ring	200	100	23	6.3 t	2.15 kg	48.85	51.50
5454-08.0	Oval-Ring	230	115	28	8.0 t	3.70 kg	67.25	70.80
5454-10	Oval-Ring	230	115	32	10.0 t	4.80 kg	95.75	101.00
5454-12.5	Oval-Ring	250	125	36	12.5 t	6.60 kg	132.00	139.00

Other sizes available on request

Wyssen plate clamp

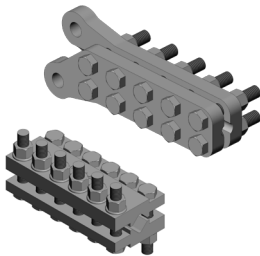

The Wyssen plate clamp functions as a guy clamp or security clamp.

The anchor cable is fixed on both lugs with a shackle on each one. The Wyssen plate clamp is also available without lugs, which was specially manufactured for the automatic Wyssen skyline clamp. This plate clamp functions to secure the steel wire cable and prevents slippage or movement of the outermost position for locked-coil cables.

Article no.	Type	Cable-ø	Weight	CHF	EUR
8.800D16	Wyssen plate clamp 6t	16 mm	12.90 kg	714.00	752.00
8.800D20	Wyssen plate clamp 6t	20 mm	12.90 kg	714.00	752.00
8.200D28-44	Wyssen plate clamp without lobes, for automatic skyline clamp	28 - 44 mm	16.20 kg	871.00	917.00
8.200D38-52	Wyssen Wyssen plate clamp without lugs, for automatic skyline clamp	38 - 52 mm	28.00 kg	1'093.00	1'151.00

Anchoring clamp

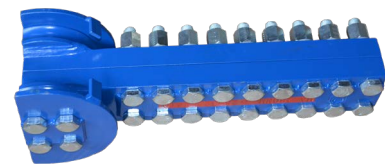

The anchoring clamp is used for holding and tensioning wire cables, such as e.g. installation of the skyline. The V-formed recess along the complete body enables a defined cable diameter range to be covered. The clamp is fastened to the attachment point with wire rope slings through the clamping tabs. Important: Before using the anchoring clamp please refer to the instruction manual.

Article no.	Type	Max. WLL tensioning force	Number bolts	Cable-ø	Length	Weight	CHF	EUR
5438D06-09	Steel	3 t	8	6 - 9 mm	24 cm	5.00 kg	on req.	on req.
5438D10-14	Steel	7 t	12	10 - 14 mm	31 cm	15.00 kg	on req.	on req.
5438D15-19	Steel	8 t	12	15 - 19 mm	34 cm	17.00 kg	on req.	on req.
5438D20-25	Steel	11 t	14	20 - 25 mm	36 cm	29.00 kg	on req.	on req.
5438D26-32	Steel	24 t	22	26 - 32 mm	56 cm	55.00 kg	on req.	on req.
5438D32-40	Steel	35 t	26	32 - 40 mm	71 cm	90.00 kg	on req.	on req.
5438D38-48	Steel	40 t	28	38 - 48 mm	76 cm	105.00 kg	on req.	on req.
5438D48-54	Steel	50 t	32	48 - 54 mm	88.5 cm	130.00 kg	on req.	on req.

Article no.	Type	Max. WLL tensioning force	Number bolts	Cable-ø	Length	Weight	CHF	EUR
5438D10-14A	Alu	7 t	12	10 - 14 mm	30 cm	6.00 kg	on req.	on req.
5438D15-19A	Alu	8 t	12	15 - 19 mm	33 cm	7.00 kg	on req.	on req.
5438D20-25A	Alu	11 t	14	20 - 25 mm	35 cm	14.00 kg	on req.	on req.
5438D26-32A	Alu	24 t	22	26 - 32 mm	52 cm	22.00 kg	on req.	on req.
5438D32-40A	Alu	35 t	26	32 - 40 mm	71 cm	38.00 kg	on req.	on req.
5438D38-48A	Alu	40 t	28	38 - 48 mm	76 cm	48.00 kg	on req.	on req.
5438D48-54A	Alu	50 t	32	48 - 54 mm	88.5 cm	54.00 kg	on req.	on req.

Cable warning device (signal ball), aviation obstacle



Various materials for marking cables, supports, valley and mountain stations (aircraft obstacles) are available from us. Markings are required from a ground height of 40 m.

Article no.	Designation	for Cable-ø	Weight	CHF	EUR
5417-1	Signal ball (orange) ø60 cm	various ø available	4.5 kg	on req.	on req.
5417-2	Signal ball CW 94-K ø90 cm		12 kg	on req.	on req.

Other sizes available on request

Ackja cable winch



The Ackja cable winch is an extremely light cable winches, which is assembled on an Ackja (a sliding hull). Even in the roughest terrain the cable winch pulls itself to the operation site and can be used for a wide variety of applications. It is operated from a steering bar. The winch unit is driven by a chainsaw motor (Stihl MS 661).

Tractive force: 9 kN • average speed: 0.8 m/s (50 m/min) • engine power: 5.4 kw / 7.3 PS (9500 rpm) • cable capacity: ø 6.5 mm, length 100 m • length, breadth, height: 1900 x 520 x 440 mm

Article no.	Type	Weight	CHF	EUR
5760KMF422	Ackja-cable winch KMF 422 (incl. 100 m cable ø 6.5 mm)	approx. 100.00 kg	7'932.00	8'350.00

Maasdam cable puller

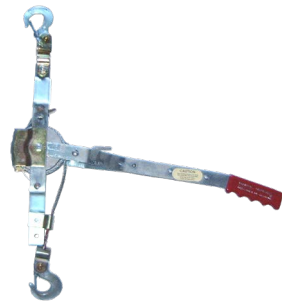

The extremely light and robust original Maasdam cable puller “made in USA” is available in the S6 version with single traction and the SB 6 with double traction. The original American device cannot be compared to Chinese imitation copies. With single traction a maximum pull length of 3.6 m is achieved, and with double traction 1.8 m. The cable puller is predominantly used in the cableway sector for installation, and primarily in pre-tensioning support guy wires.

Article no.	Type	Cable-ø	Traction length	WLL Tractive force CE / ANSI	Weight	CHF	EUR
5432S6	S6 with single traction	5 mm	3.6 m	454 kg 1'000 kg	3.50 kg	145.00	153.00
5432SB6	SB6 with double traction	5 mm	1.8 m	750 kg 2'000 kg	3.75 kg	217.00	229.00

Caution! In Europe the CE standards for tractive forces must be complied with. ANSI are the details according to the American national standard and are not valid in Europe!

Habegger Hit wire rope hoist



The high quality original Habegger wire rope hoist with alloyed light-metal housing is available for maximum tractive forces between 600 kg and 3200 kg. Overloading is protected by means of shear pin and a suitable cable designed for the wire rope hoist offers maximum safety. The Habegger wire rope hoist is used world-wide in the widest applications, and also in the cableway sector. We also offer upgrading for the hydraulic drive.

Article no.	Type	Traction	Cable-ø	Weight	CHF	EUR
5431H06	Hit 6 with lever, without cable	600 kg	6.4mm	4.80 kg	589.00	620.00
5431H06D6.4X10	Hit 6 with lever, 10 m cable, hook, sling ø6.4 mm x 1 m, without reel	600 kg	6.4mm	7.70 kg	681.00	717.00
5431H10	Hit 10 with lever, without cable	1'000 kg	8.4mm	7.70 kg	728.00	767.00
5431H10D8.4x20	Hit 10 with lever, 20 m cable, hook, with reel	1'000 kg	8.4mm	14.00 kg	900.00	948.00
5431H16	Hit 16 with lever, without cable	1'600 kg	11.2mm	13.70 kg	991.00	1'044.00
5431H16D11.2X20	Hit 16 with lever, 20 m cable, hook, with reel	1'600 kg	11.2mm	23.20 kg	1'251.00	1'317.00
5431H32	Hit 32 with lever, without cable	3'200 kg	16.2mm	23.00 kg	1'580.00	1'664.00
5431H32D16.2X20	Hit 32 with lever, 20 m cable, hook, with reel	3'200 kg	16.2mm	43.30 kg	1'992.70	2'098.00



Cable winch W-40 with Unimat circular drive

Mainline for Habegger manually operated wire rope hoist



The mainline for the Habegger manually operated wire rope hoist is specially manufactured to ensure the highest degree of safety. The cables are available with a thimble and an eyelet load hook with a safety latch at one end and at the other end with a point to push through the device.

Article no.	Type	Cable-ø	Length	Weight	CHF	EUR
5511D6.4X10M	Hit 6	6.4 mm	10 m	2.90 kg	128.00	135.00
5511D6.4X20M	Hit 6	6.4 mm	20 m	4.50 kg	162.00	171.00
5511D6.4X30M	Hit 6	6.4 mm	30 m	6.10 kg	197.00	208.00
5511D8.4X10M	Hit 10	8.4 mm	10 m	3.80 kg	155.00	164.00
5511D8.4X20M	Hit 10	8.4 mm	20 m	6.30 kg	201.80	213.00
5511D8.4X30M	Hit 10	8.4 mm	30 m	8.80 kg	257.30	271.00
5511D8.4X40M	Hit 10	8.4 mm	40 m	11.30 kg	312.90	330.00
5511D11.2X10M	Hit 16	11.2 mm	10 m	5.40 kg	171.20	181.00
5511D11.2X20M	Hit 16	11.2 mm	20 m	9.50 kg	242.70	256.00
5511D11.2X30M	Hit 16	11.2 mm	30 m	14.60 kg	319.70	337.00
5511D11.2X40M	Hit 16	11.2 mm	40 m	18.70 kg	395.00	416.00
5511D11.2X50M	Hit 16	11.2 mm	50 m	22.80 kg	468.00	493.00
5511D11.2X60M	Hit 16	11.2 mm	60 m	26.90 kg	560.00	590.00
5511D11.2X80M	Hit 16	11.2 mm	80 m	31.00 kg	733.00	772.00
5511D11.2X100M	Hit 16	11.2 mm	100 m	44.20 kg	850.00	895.00
5511D16.2X10M	Hit 32	16.2 mm	10 m	11.30 kg	278.90	294.00
5511D16.2X20M	Hit 32	16.2 mm	20 m	20.30 kg	412.70	435.00
5511D16.2X30M	Hit 32	16.2 mm	30 m	30.20 kg	553.20	583.00
5511D16.2X80M	Hit 32	16.2 mm	80 m	88.00 kg	1'742.40	1'835.00
5511D16.2X100M	Hit 32	16.2 mm	100 m	105.00 kg	2'010.00	2'116.00

All prices include reel. On request also available without reel. Other lengths and versions are available on request.

Habegger Hit-Trac power-driven hoists



The original Habegger Hit-Trac power-driven hoist offers the highest quality and safety thanks to its excellent materials, well thought-out construction and safety features. The Hit-Trac is available with a Stihl 2-stroke driving motor or an electric motor. The tractive speed of the Hit-Trac 8 is maximum 6 m/min and for the Hit-Trac 16 max. 10 m/min. All equipment is fitted with overload protection, so that highest degree of safety can be guaranteed.

Article no.	Type	Traction	Cable-ø	Weight	CHF	EUR
5431HT8-8.2	Hit-Trac 8B with Stihl 260 Motor	800 kg	8.2 mm	30.00 kg	7'700.00	8'106.00
5431HT16-11.2	Hit-Trac 16B with Stihl 2-stroke motor	1'600 kg	11.2 mm	44.00 kg	8'466.00	8'912.00
5431HT8-8.2E	Hit-Trac 16E with electric motor 1kW/230V	800 kg	8.2 mm	32.00 kg	8'048.00	8'472.00
5431HT16-11.2E	Hit-Trac 16E with electric motor 3kW/400V/6.8A	1'600 kg	11.2 mm	58.00 kg	8'466.00	8'912.00

Traction cable for Habegger power-driven hoists

Article no.	Type	Cable-ø	Length	Weight	CHF	EUR
5512D8.2X30	Hit-Trac	8.2 mm	30 m	8.80 kg	270.50	285.00
5512D8.2X50	Hit-Trac	8.2 mm	50 m	13.80 kg	387.00	408.00
5512D8.2X80	Hit-Trac	8.2 mm	80 m	22.30 kg	555.00	585.00
5512D8.2X100	Hit-Trac	8.2 mm	100 m	27.30 kg	663.00	698.00
5512D8.2X150	Hit-Trac	8.2 mm	150 m	40.70 kg	947.00	997.00
5512D8.2X300	Hit-Trac	8.2 mm	300 m	90.00 kg	2'397.00	2'524.00
5512D11.2X30	Hit-Trac	11.2 mm	30 m	14.60 kg	347.00	366.00
5512D11.2X50	Hit-Trac	11.2 mm	50 m	22.80 kg	500.00	527.00
5512D11.2X80	Hit-Trac	11.2 mm	80 m	36.00 kg	773.00	814.00
5512D11.2X100	Hit-Trac	11.2 mm	100 m	44.20 kg	918.10	967.00
5512D11.2X150	Hit-Trac	11.2 mm	150 m	76.50 kg	1'977.50	2'082.00
5512D11.2X300	Hit-Trac	11.2 mm	300 m	138.00 kg	3'178.00	3'346.00

Other lengths on request Thimble/eyelet load hook at one end, pointed at the other end, with reel.

Wyssen Avalanche Control Center

WAC.3®

Innovative user interface
for **avalanche control**





Wyssen Avalanche Control AG

The Wyssen company has been building remote avalanche control systems since 1999. In 2009, the company Wyssen Avalanche Control AG was founded, which took over this business unit .

Within 5 years, Wyssen became the market leader in Switzerland, Austria and in Norway. Meanwhile, Wyssen Towers protect ski resorts, roads and mines in Canada, USA, Chile and Andorra too.

The company sets the state-of-the-art technology and services in the branch, thanks to its innovative solutions. Examples for this are the new operating software WAC.3® for Avalanche Towers or the variety of avalanche detection systems, which are indisputably regarded today as state-of-the-art.

Wyssen Avalanche Control has installed over **870 Wyssen avalanche towers** and **150 detection systems** worldwide by 2025. The systems and software tools are operated via the WAC.3® information platform by **over 1'100 active users**.

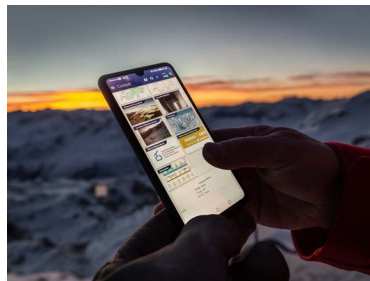

Safety through **innovation**



**avalanche
control**

Small Cableway 100kg

The ideal solution for short distances and small loads

The Wyssen small cableway is ideally suited for transporting baggage or building material to remotely situated mountain, club or holidays homes. The maximum cableway length is 100 m. The carriage is very light with 34 kg and its simple and uncomplicated construction makes it very inexpensive. The cableway is suitable for skyline cable diameters of \varnothing up to 9 mm. The drive unit is a small electric winch that works at an operating voltage of 230 V. Operation is simple and uncomplicated with a switch directly on the winch, which can optionally be supplied with radio remote control. In the case of convex terrain, supports with a suspension cable saddle can also be built. Transporting people on the small cableway is strictly prohibited.

Technical Data

Loading deck dimensions	75 x 52 x 25 cm
Load capacity	100 kg
max. cableway length	100 m

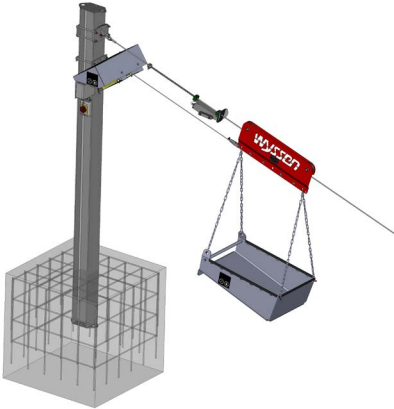
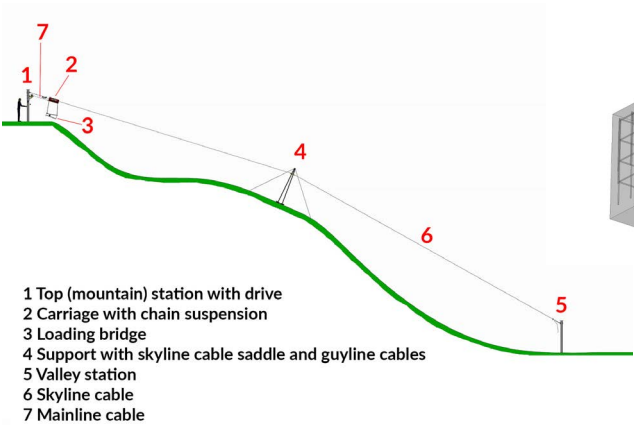



Automatic skyline clamp

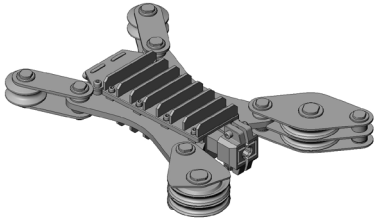

The automatic skyline clamp is used predominantly for rapid and secure tensioning of skylines. It may be used for most types of steel wire cables, of \varnothing 12 mm to 60 mm with a maximum tension capacity of up to 48 t. Clamping is automatically effected, without any elaborate bolting. Clamping jaws are available for different cable diameters and all types can be exchanged. For odd cable diameters the next largest size of clamp diameter must be used.

***corresponds max. operating voltage**

Article no.	Type	WLL*	Weight	CHF	EUR
25.500BC	BC (2-piece set)	8 t	60.50 kg	6'239.00	6'568.00
25.500A	A	8 t	24.50 kg	2'414.00	2'542.00
25.500B	B	8 t	28.10 kg	2'745.00	2'890.00
25.500C	C	8 t	32.50 kg	3'469.00	3'652.00
25.520	clamping jaws (price/piece)	8 t	4.00 kg	486.00	512.00

The clamping jaws are available for cable- \varnothing 12/14/16/18/20 mm and for type BC/A/B/C inclusive.
Tensioning cable- \varnothing max. 12 mm

Article no.	Type	WLL*	Weight	CHF	EUR
25.350A	A (without clamping jaws)	12 t	29.00 kg	2'251.00	2'370.00
25.350B	B (without clamping jaws)	12 t	35.00 kg	3'097.00	3'260.00
25.350C	C (without clamping jaws)	12 t	42.00 kg	3'836.00	4'038.00
25.304	clamping jaws (price/piece)	12 t	7.38 kg	487.00	513.00

The clamping jaws are available for cable- \varnothing 16/18/20/22/24/26/28/30/32 mm.
Tensioning cable- \varnothing max. 12 mm

Article no.	Type	WLL*	Weight	CHF	EUR
25.200BC	BC (2-piece set)	22 t	199.00 kg	17'111.00	18'012.00
25.200A	A	22 t	85.00 kg	6'713.00	7'067.00
25.200B	B	22 t	94.00 kg	8'243.00	8'677.00
25.200C	C	22 t	105.00 kg	8'869.00	9'336.00
25.215	clamping jaws (price/piece)	22 t	16.00 kg	1'425.00	1'500.00

The clamping jaws are available for cable- \varnothing 20/22/24/26/28/30/32/34/36/38/40/42/44 mm and for type BC/A/B/C inclusive.
Tensioning cable- \varnothing max. 16 mm

Article no.	Type	Tension capacity*	Weight	CHF	EUR
25.2200BC	BC (2-piece set)	32 t	208.00 kg	21'744.00	22'889.00
25.2200A	A	32 t	86.00 kg	8'243.00	8'677.00
25.2200B	B	32 t	98.00 kg	10'268.00	10'809.00
25.2200C	C	32 t	110.00 kg	11'478.00	12'083.00
25.215	clamping jaws (price/piece)	32 t	16.00 kg	1'425.00	1'500.00

The clamping jaws are available for cable-ø 20/22/24/26/28/30/32/34/36/38/40/42/44 mm and for type BC/A/B/C inclusive.

Tensioning cable-ø max. 16 mm

Article no.	Type	Tension capacity*	Weight	CHF	EUR
25.400BC	BC (2-piece set)	48 t	625.00 kg	42'543.00	44'783.00
25.400A	A	48 t	255.00 kg	16'642.00	17'518.00
25.400B	B	48 t	295.00 kg	20'173.00	21'235.00
25.400C	C	48 t	330.00 kg	22'371.00	23'549.00
25.415	clamping jaws (price/piece)	48 t	34.00 kg	2'922.00	3'076.00

The clamping jaws are available for cable-ø 40/42/44/46/48/50/52/54/56/58/60 mm and for type BC/A/B/C inclusive.

Tensioning cable-ø max. 22 mm

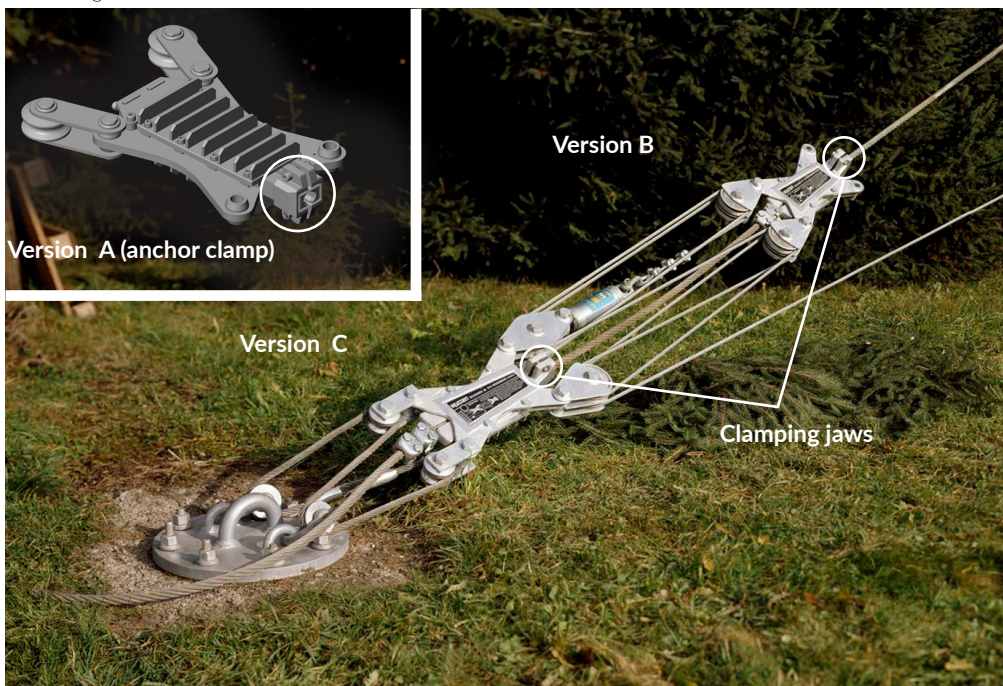

For application on several cableways, a special type A skyline clamp is available, which then can be used on the respective cableway as an anchor clamp. A set consisting of A, B and C can be used with this for two cableways. For the tensioning device, we offer various types of tension measuring instruments in addition to the suitable rock anchor plates and cable warning devices (signal balls).

Electronic tension measurement device Wyssen



Electronic Tensioning-Device-Shakle

The Wyssen electronic tension measurement device has been specially manufactured for the Wyssen automatic skyline clamp. The skyline cable tension is measured in the tensioning cable at the tension gauge shackle during tensioning. Using the tension gauge with load measuring pins the effective value is measured directly (no multiplication necessary) in the automatic skyline clamp. The device is delivered with 10 m of cable for reading off from a distance. The measurement can be permanently read off outside the danger zone and with the measuring pins during tensioning and also during operation.

Article no.	Type	WLL	Weight	CHF	EUR
25.300M	Wyssen electronic tension measurement device for 12 t skyline clamp	12 t	12.00 kg	7'148.00	7'525.00
25.200M	Wyssen electronic tension measurement device for 22 t skyline clamp	22 t	12.00 kg	7'148.00	7'525.00
25.2200M	Wyssen electronic tension measurement device for 32 t skyline clamp	32 t	12.00 kg	7'148.00	7'525.00
25.1050	Electronic Tensioning-Device-Shakle 7/8", incl. cable roll, 10 m cable, measuring- and display device	6.5 t	4.42 kg	2'615.00	2'753.00



Electronic tension measurement device with measuring pins.

PIAB tension measurement device



The PIAB tension measurement device is amongst other things used with the automatic skyline clamp. The analogue measuring instrument needs no batteries. The measurement is made in the tensioning cable; therefore the multiplication factor of the sheave block must always be taken into account. The measurement may only be carried out when at a standstill. The PIAB tension measurement device is delivered with a shackle and a wooden box

Article no.	Type	WLL	Weight	CHF	EUR
5430-1	PIAB	1 t	3.50 kg	on request	on request
5430-2	PIAB	2 t	11.00 kg	on request	on request
5430-3	PIAB	3 t	11.00 kg	on request	on request
5430-5	PIAB	5 t	19.50 kg	on request	on request
5430-10	PIAB	10 t	34.15 kg	on request	on request

Wyssen compass



The Wyssen compass has been specially developed for work in rough terrain and thanks to its very steep vision predominantly used in the mountains for the construction of cableways etc. For measuring out cableway routes, the Wyssen compass continues to be indispensable! The instrument permits measurements of horizontal and vertical angles as well as azimuths and is very well suited for levelling work. The compass is delivered in the standard version with the compass casing 400g (Gon), but is also available on request at the same price with 360°.

Article no.	Type	Weight	CHF	EUR
5215MI4007-OK_400G	Wyssen-Universalcompass 400g without inclinometer	0.38 kg	952.00	1'003.00
5215MI4007	MI-4007, with built-in inclinometer	0.38 kg	1'267.00	1'334.00
5215MS8001	Suspension device for screwing into wood	0.06 kg	90.70	95.50
5215MS8002	Suspension device for clamping onto range poles	0.09 kg	128.00	135.00
5215MB9901_400G	Compass casing incl. ring MK2001.2	0.01 kg	86.40	91.00
5219-2.5	Jalon wood (PVC coated), Classification 50 cm, 2.5 m	1.10 kg	35.00	36.90

We are your disposal for any repairs and spare parts.

Skymule - Plantation Cableway

The environmentally friendly transport solution for your plantation

The low cost Wyssen Skymule is ideal for transport downhill in steep terrain. Thanks to its simple, fast and flexible design, the Skymule enables efficient and speedy transport over steep terrain.

Advantages

- Unlimited cableway length possible
- Fast and simple assembly and removal
- Any number of supports can be assembled
- High productivity -> several loads can be transported simultaneously
- Max. Load capacity: 100 kg
- Skymule only weighs 4.5 kg -> easy to carry
- Environmentally friendly: No operating power/motor necessary, transport is by gravity
- Speed control by wear-free propeller air brake
- Simple hoisting of the load by means of pulley block
- Loading and unloading can be carried out flexibly at any position
- Slow and controlled delivery to the valley





Inclinometer



Inclinometers are used for measurements of heights and gradients as well as for levelling and measurements of distances. Due to its own weight the inclinometer always levels off absolutely vertically. In addition the MC 1004 is delivered with a small scale plate, in order to determine the approach to a wall. The two collimators have a multi-divided scale.

Article no.	Typ	Weight	CHF	EUR
5216MC1004	Inclinometer MC 1004 with 2 magnifying glasses and scale	0.25 kg	340.00	358.00

Terrain measurement device



The proven, lightweight and compact thread measuring device in a sturdy case is used to measure the length of cableways. The thread is 2700 m long and biodegradable. The case can be easily attached to a belt. The counting unit can be easily reset at the push of a button.

Article no.	Type	Weight	CHF	EUR
5217	Terrain measurement device Haglöf Walktax 2,700 m measuring thread	0.48 kg	226.00	238.00
5217S	Replacement cord 2,700 m	0.09 kg	13.50	14.30

Multi-tree anchor



The multi-tree anchor is designed to distribute the skyline tension over several trees. If there are not enough strong anchor trees for conventional anchoring, the skyline can be anchored using the 12-fold multi-tree anchor with up to 7 trees and with the 4-fold anchor up to 3 trees. If the application is done correctly (wrapped around the tree just once) the tractive forces are distributed evenly over the tree anchors.

Article no.	Type	Max. WLL	guy line cable / skyline cable-ø	Weight	CHF	EUR
8.600	2.5 / 12-fold	12 t	max. ø 12mm / ø 28 mm	10.30 kg	1'906.00	2'007.00
8.600-6	2.5 / 6-fold	12 t	max. ø 12mm / ø 28 mm	11.30 kg	1'906.00	2'007.00
8.500	5 / 12-fold	33 t	max. ø 16 mm / ø 38 mm	25.00 kg	2'737.00	2'882.00
8.500-6	5 / 6-fold		max. ø 16 mm / ø 38 mm	25.00 kg	2'737.00	2'882.00
8.700	10 / 12-fold	32 t	max. ø 26 mm / ø 44 mm	on request	3'739.00	3'936.00
8.650	3-point skyline bracket, 4- fold	12 t	max. ø 28 mm / ø 28 mm	15.50 kg	2'243.00	2'362.00

Cable tensioner



The cable tensioner is employed on the cable winch anchor cable. The anchor cable can be tensioned as desired with the adjusting screw and the cable winch aligned exactly. Correction and re-alignment of the cable winch is possible at any time with little effort.

Article no.	Type	for cable-ø	Weight	CHF	EUR
73.500	2.5	8 - 12 mm	4.93 kg	496.00	523.00



Rock anchor plate

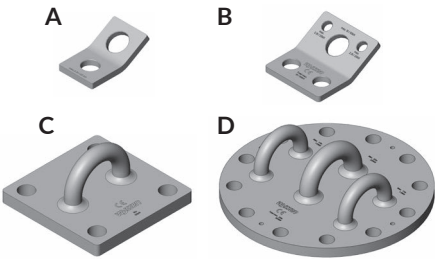

The rock anchor plates are used in good rock as anchors, such as e.g. for skyline, guy wires, etc. They are available with up to a maximum WLL of 22 tonnes with “12 holes”. With the Wyssen rock anchor system anchor sleeves are used, which also permit lateral traction on the anchor plate. Without sleeves the anchor plates serve at the same time as drilling jigs. Required accessories, such as anchor rods in various lengths, expansion heads and anchor sleeves are also available from us

Article no.	Type	Max. WLL	Weight	CHF	EUR
36.540B	1-hole (A)	2.5 t	1.56 kg	111.00	117.00
36.535	2-hole (B)	5 t	5.30 kg	183.00	193.00
36.530B	4-hole (similar C)	5 t	9.89 kg	716.00	754.00
36.530A	4-hole (C)	8 t	23.00 kg	816.00	859.00
36.525	8-hole (similar D)	12 t	46.00 kg	1'473.00	1'551.00
36.520	12-hole (D)	22 t	66.00 kg	2'283.00	2'404.00

You will find the corresponding anchor rods, expansion heads and anchor sleeves on the next page.

Accessories for the rock anchor plate

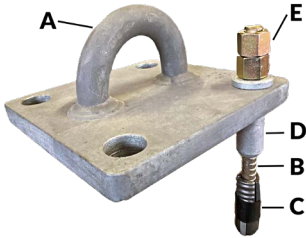

(A) Various anchor plates

The anchor rods must be used in different lengths at any one time, so that the rock is stressed at different depths. The required expansion heads are also available for the anchor rods. The anchor sleeves serve to enable lateral traction to be applied to the anchor plate. Without anchor sleeves the anchor plate is used as a drilling jig. Anchor rods and anchor sleeves can be re-used after checking. The drill holes are drilled between 38 - 41 mm depending on the length of the anchor rod.

Article no.	Type	Length	Weight	CHF	EUR
5472FAGL0.4	(B) Anchor rod ø20 (without nut)	0.4 m	1.00 kg	8.30	8.80
5472FAGL0.6	(B) Anchor rod ø20 (without nut)	0.6 m	1.50 kg	11.30	11.90
5472FAGL0.8	(B) Anchor rod ø20 (without nut)	0.8 m	2.00 kg	14.20	15.00
5472FAGL1.0	(B) Anchor rod ø20 (without nut)	1.0 m	2.50 kg	17.20	18.20
5472FAGL1.2	(B) Anchor rod ø20 (without nut)	1.2 m	3.00 kg	20.10	21.20
5472FAGL1.5	(B) Anchor rod ø20 (without nut)	1.5 m	3.75 kg	24.60	25.90
5472FAGL2.0	(B) Anchor rod ø20 (without nut)	2.0 m	5.00 kg	32.10	33.80
5472FAGL2.5	(B) Anchor rod ø20 (without nut)	2.5 m	6.25 kg	39.40	41.50
5472FAGL3.0	(B) Anchor rod ø20 (without nut)	3.0 m	7.50 kg	46.90	49.40
547120F63053	(C) Concrete-/Rock anchor 3-shell (Expanding Head)		0.40 kg	8.60	9.10
36.114B	(D) Anchor sleeve		0.88 kg	61.20	64.50
36.114BKD20	Anchor sleeve short for adhesive anchor		0.23 kg	42.60	44.90
547120F22030G	(E) Hexagon nut (replacement nut)		0.20 kg	7.00	7.40

Wyssen titanium anchor

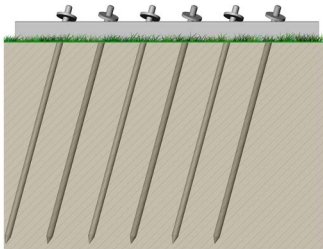

The Wyssen titanium anchor is delivered complete with 6 pins. In compact and good ground the anchor can be loaded with 1 to 3 tonnes. The titanium anchor is used predominantly in free terrain, where no other anchoring possibilities exist. It serves as an anchor for low loading, such as e.g. for small cable winches. The pins can be pulled out on the plate with the foot-operated winch. In the case of soft soil, several anchors can be coupled together.

Article no.	Type	WLL	Weight	CHF	EUR
36.1310A	Wyssen incl. 6 pins and shackle 5/8"	2 - 3 t	47.00 kg	843.00	888.00
36.1312	Pin 1 m, individual		5.00 kg	105.00	111.00

Anchor bracket staple with cross-plateanchors

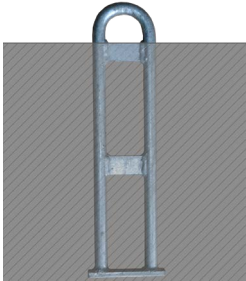

Anchor bracket staples for support guy lines with or without cross-plate are also available and depending on the type can be loaded up to 10 tonnes. For setting in concrete the anchor plates are used with cross-plates and without cross-plates for cementing into rock.

Article no.	Type	for shackle	WLL	Weight	CHF	EUR
36.660	ø 20 cm	1/2"	2 t	2.30 kg	111.00	117.00
36.661	ø 25 cm	5/8"	3 t	5.20 kg	183.00	193.00
36.662	ø 30 cm	3/4"	5 t	9.30 kg	288.00	304.00
36.663	ø 35 cm	7/8"	8 t	13.50 kg	377.00	397.00
36.664	ø 40 cm	1"	10 t	17.50 kg	469.00	494.00

Anchor brackets for concrete anchors

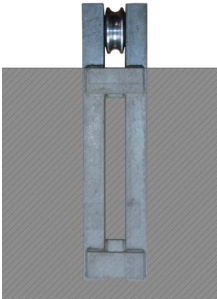

The finished anchor brackets are used for concrete anchors, which are available in various sizes up a load capacity of 48 tonnes. Plans for the concrete foundation (concrete quality P 300) are also included.

Article no.	Type	WLL	Weight	CHF	EUR
36.610	telephone cable anchor	3 t	6.20 kg	761.00	802.00
36.615	Balloon cable anchor	6 t	on request	on request	on request
36.620	2.5	12 t	43.00 kg	1'308.00	1'377.00
36.630	5	24 t	86.00 kg	2'511.00	2'644.00
36.640	10	48 t	on request	3'697.00	3'892.00

Anchor brackets for automatic skyline clamp

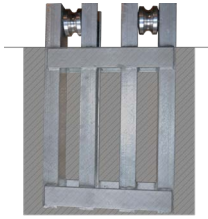

Special anchor brackets are also available for the automatic skyline clamps, which depending on the type can be used for a maximum load capacity of 48 tonnes. Plans for the concrete foundations are also included.

Article no.	Type	WLL	Weight	CHF	EUR
36.625	2.5	12 t	37.00 kg	1'265.00	1'332.00
36.635	5	24 t	88.00 kg	2'452.00	2'582.00
36.645	10	48 t	on request	5'173.00	5'446.00
36.636	10 with additional skyline anchor	48 t	350.00 kg	7'200.00	7'579.00

Rotatable anchor

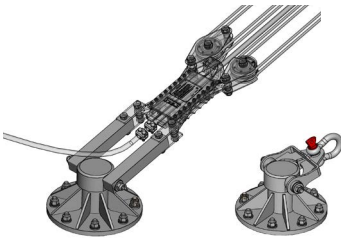

The rotatable anchor (star-patterned anchoring system) can be swivelled horizontally 360° and vertically 45°. This enables cable lines to be laid out in any direction from the anchoring point.

The shackle version is versatile and can be used, for example, to anchor the cable of a snow groomer cable winch. The 8-hole anchor is bolted onto rock or a concrete base.

Article no.	Typ	WLL	Weight	CHF	EUR
36.100	2.5	12 t	105.00 kg	4'882.00	5'139.00
36.100S	S (Shakle)	12 t	94.00 kg	5'320.00	5'600.00
36.225	5	20 t	210.00 kg	12'031.00	12'031.00

Wire rope cutter



Wire rope cutting made easy. The combination of ratchet and long handholds makes it possible to cut wire ropes with little effort. Face-ground and especially hardened blades made out of high-quality tempered steel. Blades can be unlocked in any cutting position. Impact resistant laminated and hardened handholds.

Article no.	Type	Flexible wire ropes	Compressed wire ropes	Weight	CHF	EUR
5240SCSZ20	SCSZ20	max. ø 20 mm	max. ø 16 mm	1.90 kg	431.00	454.00
5240SCSZ30	SCSZ30	max. ø 30 mm	max. ø 25 mm	5.30 kg	598.00	630.00

Splicing tool



The splicing tool is available either as a complete set or individually. In the following list you can see all that is required for splicing a steel wire cable and everything that is contained in the splicing tool case.

Article no.	Type	contained in case	Weight	CHF	EUR
38.100	Splicing tool case with contents up to cable ø 24 mm		13.00 kg	2'386.00	2'512.00
38.115	Round splicing pin ø 18 mm / 550 mm	1 pc	0.92 kg	193.00	204.00
38.120	Round splicing pin ø 12 mm / 260 mm	2 pcs	0.20 kg	122.00	129.00
38.125	Flat splicing pin 320 mm	1 pc	0.43 kg	207.00	218.00
38.130	Flat iron with hole ø 8 and 10 mm	2 pc	0.39 kg	34.20	36.00
38.135	Offset splicing pin ø 8 mm	1 pc	0.08 kg	175.00	185.00
38.140	Offset splicing pin ø 15 mm	1 pc	0.30 kg	237.00	250.00
5240-30900	Stranded wire stretching device for max. cable ø 16 mm / stranded wire-ø 5.5 mm	1 pc	1.50 kg	617.00	650.00
5240C16	Felco cable cutters C-16	1 pc	2.30 kg	379.00	399.00
5240C7	Felco cable cutters C-7	1 pc	0.32 kg	70.40	74.20
5211G2	Folding ruler 2m	1 pc	0.13 kg	10.10	10.70
5240B230	Pincers 230 mm	1 pc	0.43 kg	22.40	23.60
5240G250	Locking pliers 250 mm	1 pc	0.06 kg	33.60	35.40
5241-01	Mounting knife	1 pc	0.07 kg	18.00	19.00
5245-2	Copper hammer 1 kg	1 pc	1.03 kg	64.80	68.30
5266-01	pair of working gloves	1 pc	0.19 kg	5.80	6.20
5267-10	Insulating tape 20 m	1 pc	0.04 kg	3.50	3.70
5268-01	Hemp plaits	3 pcs	0.12 kg	6.90	7.30
5269-01	Chalk	2 pcs	0.01 kg	1.30	1.40
5505-01	Roll of binding wire ø 2.5 x 25	1 pc	1.14 kg	23.00	24.30
5270-ETUI	Splicing tool case	1 pc	1.75 kg	54.70	57.60

All price details for one article each.

Climbing Kit Wyssen



Wyssen safety belt

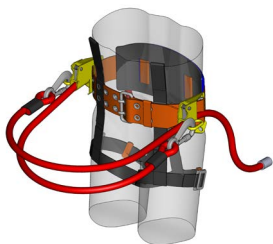

You receive from us the complete climbing equipment required for the safe ascent of trees. The tried and tested Wyssen safety belt with 2 ropes is specially constructed so that obstacles such as branches, cable guys etc. never have to be climbed over unprotected. The safety rope consists of a nylon braided steel cable, so that unintended cutting through is prevented. Damaged ropes are available in exchange.

Article no.	Type	Weight	CHF	EUR
24.300BS	2-Cable Wyssen Safety Harness (Climbing harness) Waist harness made of nylon, width 80 mm, for body weights up to 100 kg, with leg loops, 2 clamp cases /safety latches, 2 reinforced special cables, continuously adjustable up to lengths of 3.1 m, including instruction manual. Tested in compliance with SUVA (regulation EU2016/425)	4.00 kg	1'101.00	1'159.00
5580H	Hammer holster for Wyssen safety belt	0.08 kg	24.60	25.90
5580T	3-piece belt (braces)	0.09 kg	20.20	21.30

Wyssen climbing spikes



The climbing spikes are used for climbing trees of all types. With the cushioned leg protectors made of aluminium and the weatherproof synthetic straps, the highest degree of safety and comfort is guaranteed. The spikes are replaceable and are available as individual spare parts, as are all other parts.

Article no.	Type	Weight	CHF	EUR
24.100	Wyssen climbing spikes Price per pair interchangeable spikes, aluminium leg protector weatherproof synthetic straps with strap eyelets for fixing on the spikes	3.86 kg	510.00	537.00

Icom Radio Telephone



All our radio-controlled carriages can be operated with the ICOM radio-telephone. In addition you can get all ICOM accessory parts from us individually.

The Icom IC-F34GS VHF radio telephone is no longer available. All accessories for the radio telephone is still available.

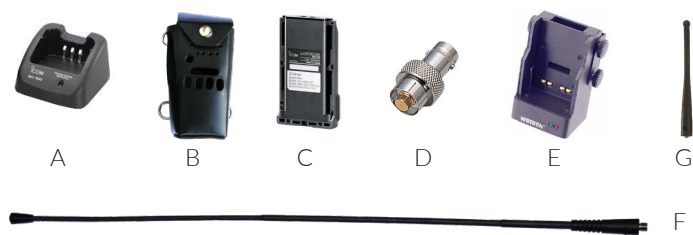

Article no.	Type	Weight	CHF	EUR
5420I-TL-BC160	(A) Desktop charger BC-160	0.35 kg	75.40	79.40
5420I-F34-3PT	(B) leather carrying case with 3-point belt (Wyssen)	0.24 kg	90.00	94.80
5420I-AKKU-BP232	(C) Replacement battery BP232 7.2V (1,900 mAh)	0.13 kg	127.00	134.00
5420I-BNC-AD-98F	(D) BNC Antenna adapter AD-98F	0.08 kg	33.60	35.40
5420WTC659	(E) KFZ-Charging cradle for F34 12/24 V	0.39 kg	320.00	337.00
5420Z-FSP2_H-MXTAIT	(F) Flex-antenna 430 mm for larger range	0.46 kg	84.80	89.30
5420I-FA-SC55V-2	(G) Antenna ICOM VHF-antenna	0.03 kg	22.50	23.70

Remarks about ICOM radio equipment for carriage operation:

For customers who already possess ICOM mobile radios, for reasons of compatibility, we recommend using the same type of equipment.

Advantages of the Icom F34 as opposed to Motorola GP340:

- Buttons for clamping and opening are large and can be easily operated when wearing gloves
- Standard-battery 2,000 mAh
- Leather carrying case on top closed over channel switch and volume control
- Display with channel indicator

Disadvantages of the Icom F34 as opposed to Motorola GP340:

- For the slack-puller the channel must be changed to switch off the motor

Motorola Radio Telephone



All our radio-controlled carriages can be operated with the Motorola radio-telephone. In addition you can get all Motorola accessory parts from us individually.

Article no.	Type	Weight	CHF	EUR
5420M-GP340-VHF-SET	Motorola GP340 VHF SET hand radio telephone, without display, without keypad, max. 16 channels, with antenna, with PMNN4151 battery 7.5 V (1,300 mAh), desktop charger, leather case with 3-point belt (Wyssen), incl. alignment and programming	2.12 kg	1'211.00	1'275.00



A



B



C



D



E



F



H



G

Article no.	Type	Weight	CHF	EUR
5420M-TL-MDHTN3001	(A) Desktop charger	0.88 kg	113.00	119.00
5420M-GP340-3PT	(B) leather carrying case with 3-point belt (Wyssen)	0.20 kg	151.00	159.00
5420M-PMNN4151	(C) Replacement battery PMNN4151 7.5 V (1,300 mAh)	0.22 kg	135.00	143.00
5420M-NF-HLN9716	(D) NF Adapter HLN 9716	0.02 kg	42.60	44.90
5420M-BNC-HL9756	(E) BNC Adapter HL 9756	0.08 kg	24.60	25.90
5420WTC620	(F) KFZ-Charging cradle for F34 12/24 V	0.39 kg	311.00	328.00
5420Z-FSP2_H-MXTAIT	(G) Flex-antenna 430 mm for larger range	0.46 kg	84.80	89.30
5420M-PMAD4015	(H) Antenna Motorola VHF 14cm (155-174MHz)	0.03 kg	22.50	23.70

Remarks about Motorola radio equipment for carriage operation:

For customers who already possess Motorola mobile radios, for reasons of compatibility, we recommend using the same type of equipment.

Advantages of the Motorola GP340 as opposed to Icom F34:

- To stop the motor of the slack-puller, the orange button next to the antenna is pressed, without changing the channel.

Disadvantages of the Motorola GP340 as opposed to Icom F34:

- Buttons for clamping and opening are relatively small
- Leather carrying case on top open over channel switch and volume control
- No display

Headphones and microphone for radio



For both Motorola and ICOM radio equipment you can get suitable headphones and microphones from us.
Other Peltor products on request.

Artikcle no.	Type	Weight	CHF	EUR
5420P-MT74H52A-111	Headset Peltor with microphone (without cable) 3M, PELTOR CH-3 Headset with int. PTT, headband	0.61 kg	318.00	335.00
5420P-HT52A-112	Headset Peltor without microphone (without cable) 3M, PELTOR CH-3 Headset Listen Only	0.61 kg	153.00	162.00
5420P-FLX2-32	3M™ PELTOR™ Flex 2 Cable, suitable for Motorola GP340 - Headset with microphone	0.06 kg	90.80	95.60
5420P-FLX2-64	Peltor Flex 2 cable - compatible with Icom F34 - headphones with microphone	0.06 kg	101.85	108.00
5420P-FLX2-202	Peltor Flex 2 cable – compatible with Icom F34 and Motorola GP340 – headphones without microphone*	0.06 kg	56.90	59.90

*For Motorola, the NF adapter 5420M-NF-HLN9716 is also required!

Wyssen fan articles

Article no.	Type	Weight	CHF	EUR
5990-LONGSLEEVE	Wyssen-Longsleeve, Size S, XL, XXL	0.09 kg	20.20	21.30
5990-MESSERWSR	Wyssen-Knife	0.07 kg	16.60	17.50
5990-HUT	Wyssen-Hat	0.09 kg	20.00	21.10
5990-KAPPE	Wyssen-Cap	0.08 kg	20.00	21.10





Orders

Wyssen Seilbahnen AG

3713 Reichenbach i.K.
Switzerland

Tel.: +41 (0) 33 676 76 76

info@wyssen.com
www.wyssen.com

Opening hours:
07.30am - 12.00am
13.15pm - 17.00pm

Wyssen Austria GmbH

6020 Innsbruck
Austria

Tel.: +43 512 2193 4600

austria@wyssen.com
www.wyssen.com

Wyssen Online Shop

<https://shop.wyssenseilbahnen.com>



Scan me for all cableway movies:

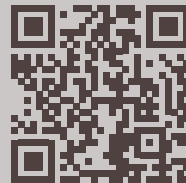

Our general terms and conditions of sale are valid. All information is given without any guarantee. Subject to change without prior notice. Prices are subject to change without notice. All CHF price details are valid in Swiss Francs ex factory. VAT not included. Prices in EUR are reference values and are based on the the current exchange rate.

0.95

Swiss Made since 1926



Wyssen Seilbahnen AG

3713 Reichenbach i.K.
Switzerland

Tel.: +41 (0) 33 676 76 76

info@wyssen.com
www.wyssen.com

Wyssen Austria GmbH

6020 Innsbruck
Austria

Tel.: +43 512 2193 4600

austria@wyssen.com
www.wyssen.com



Important Notice to Wyssen Seilbahnen AG Products in this Brochure:

No binding offer, we reserve the right to enter or refuse to enter into an agreement, and to make changes of our products without prior notice. All technical information is for reference only. The pictures and diagrams do not always represent the original versions of machinery and equipment. Equipment, instruction and protection of staff handling the products are the exclusive responsibility of the owner/user of the product.

Wyssen Seilbahnen AG does not accept liability of any kind, be it for direct or consequential damages (including, but not limited to, loss of profits, business and/or risks or damages to goodwill) arising as a consequence of reliance or only partial reliance upon any information herein provided by Wyssen Seilbahnen AG. The owner/user is responsible for determining the suitability of the products for their intended use and its compliance with the current regulations in force in the country of use. For our customers, our General Terms of Contract and Delivery are applicable; they are available on our website.

WYSSSEN
switzerland • **seilbahnen**